

**Windshield Wiper Motor**

Base Part Number: 17508

**Removal**

1. Remove the wiper linkage assembly.  
Refer to: [Wiper Linkage Assembly](#) (501-16 Wipers and Washers, Removal and Installation).
2.
  1. Detach the RH windshield wiper link from the windshield wiper motor crank and position it aside.
  2. Remove and discard the grease cover.
  3. Detach the LH windshield wiper link from the windshield wiper motor crank and position it aside.
  4. Remove the lower grease cup/seal.

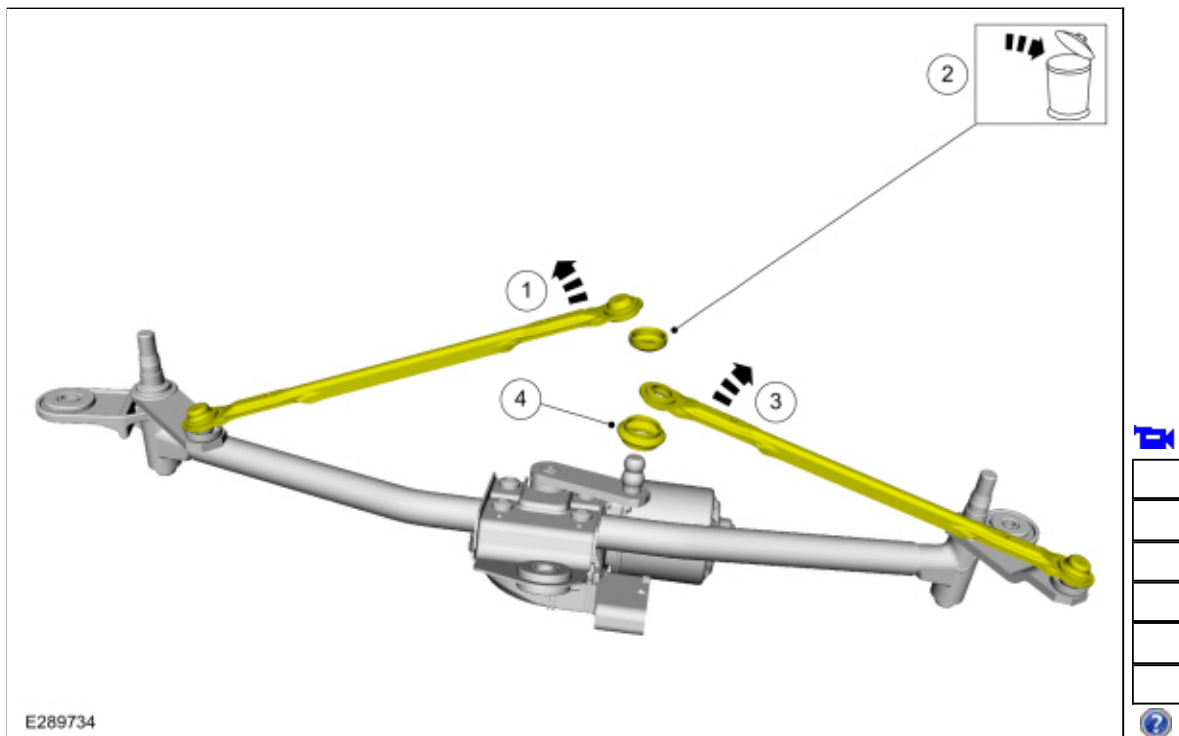

3. **NOTE:** Note the position of the component before moving.

Rotate the windshield wiper motor crank to gain access to all of the windshield wiper motor mounting screws.

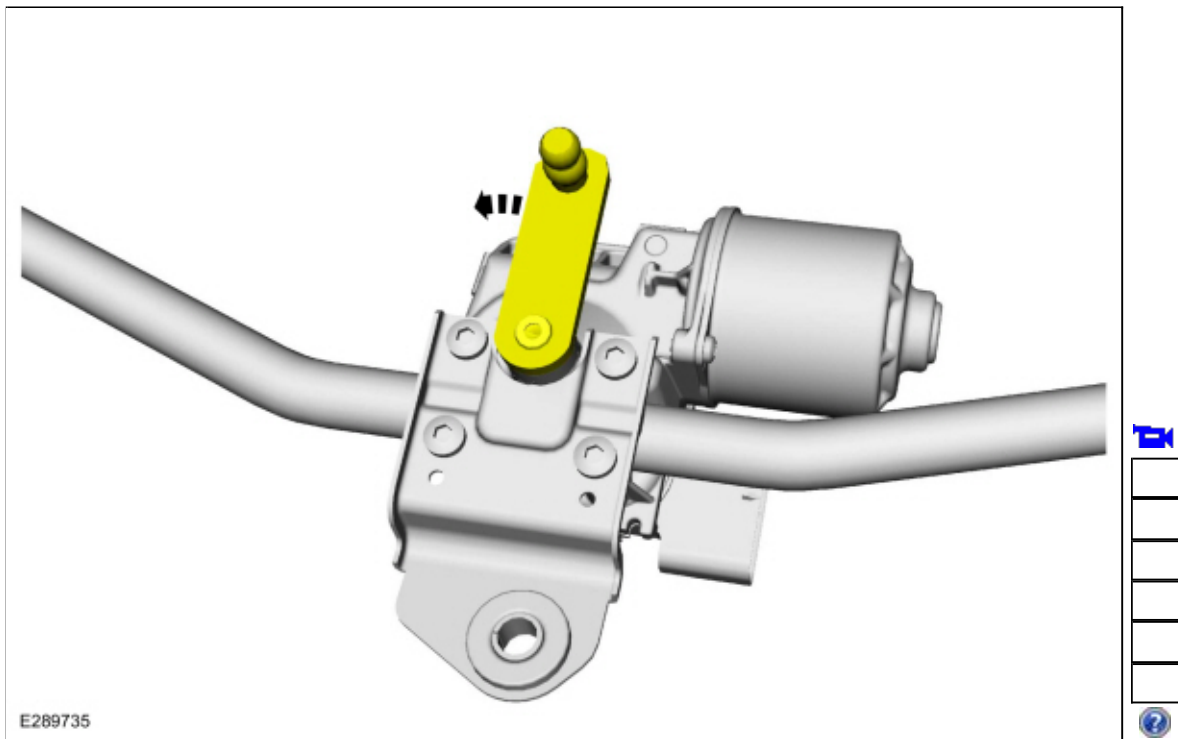

4. **NOTE:** Note the position of the components before removal.

Remove and discard the windshield wiper motor mounting screws, Position aside the bracket and remove the windshield wiper motor.

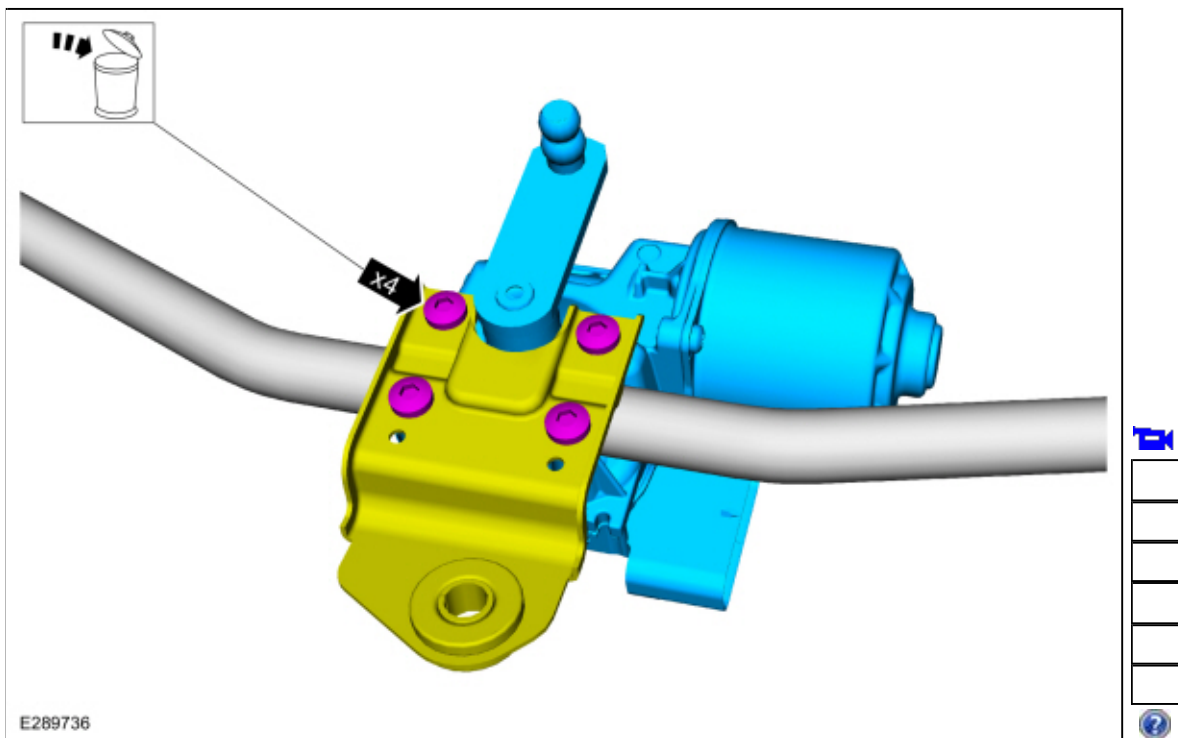

## Installation

1. Install the windshield wiper motor, Position the bracket and install the new windshield wiper motor mounting screws.  
*Torque: 80 lb.in (9 Nm)*

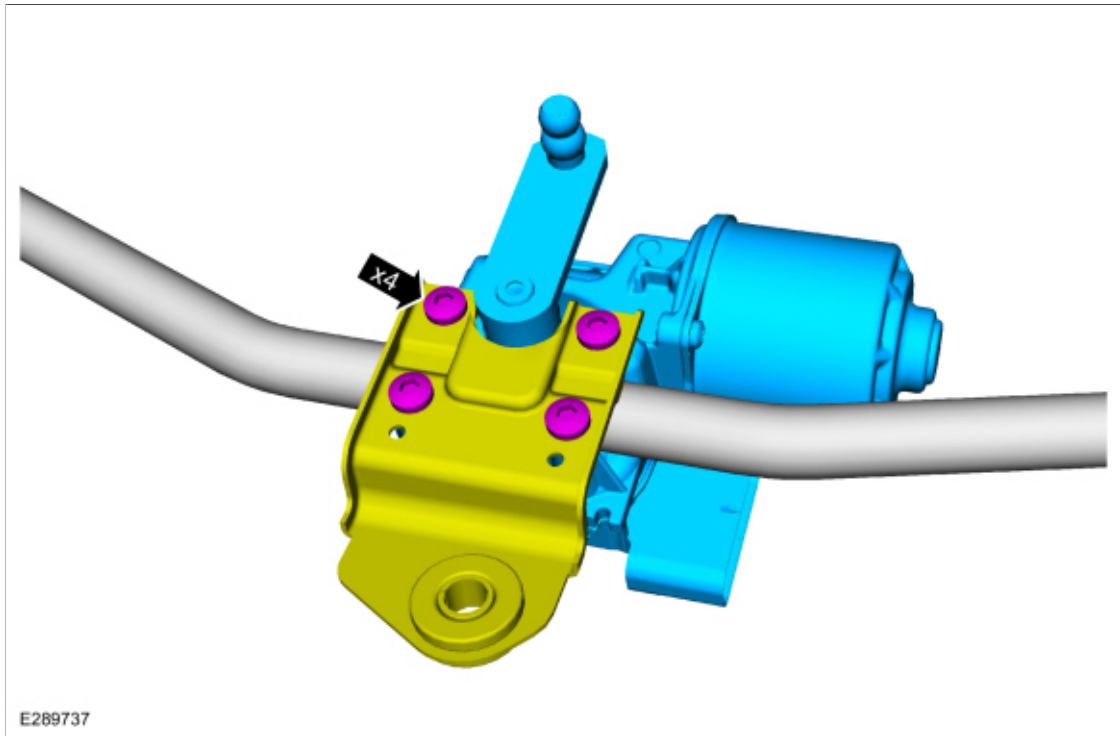

2. Rotate the windshield wiper motor crank to the park position.

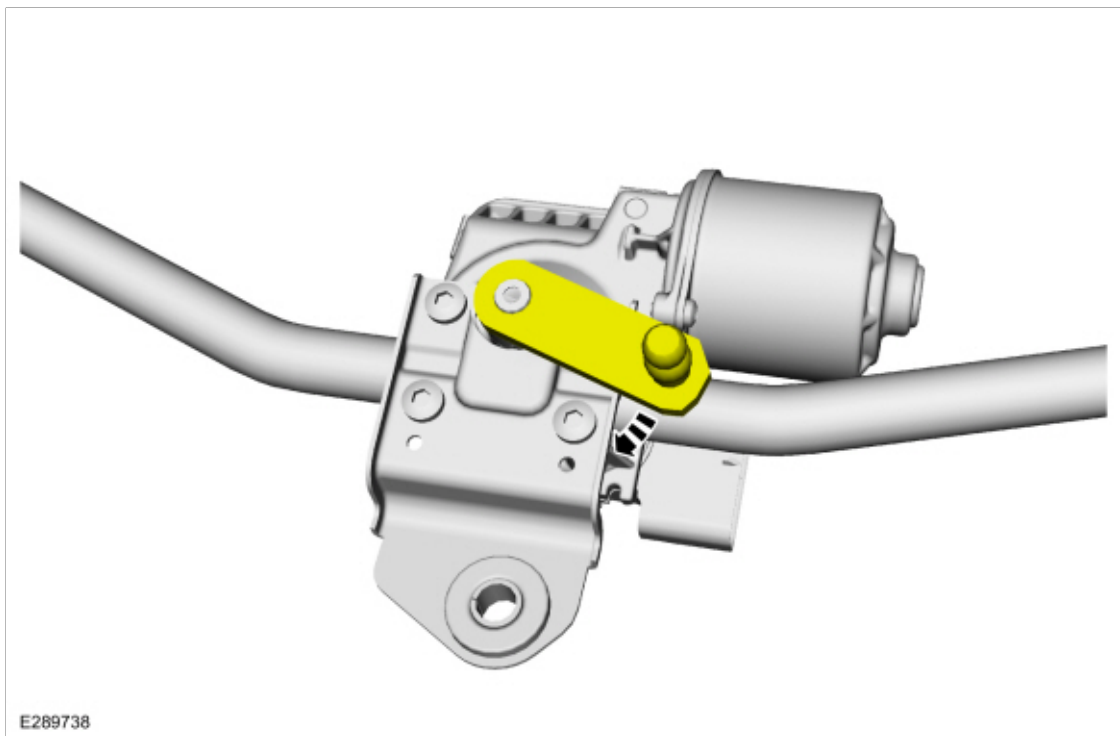

3. Clean and inspect the components before assembly.
  - Remove all old grease and inspect for damage.

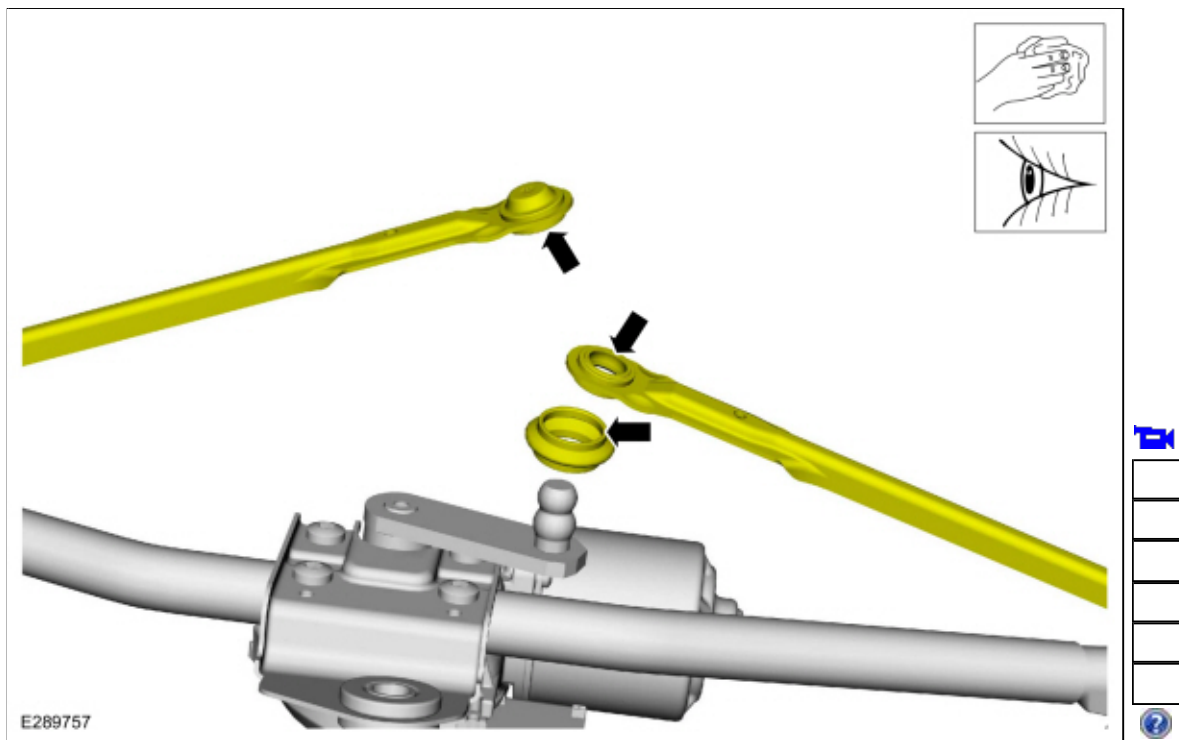

4. **NOTE:** A new grease cover and grease is supplied with service package.

Apply supplied grease to the two ball caps and the grease cover.

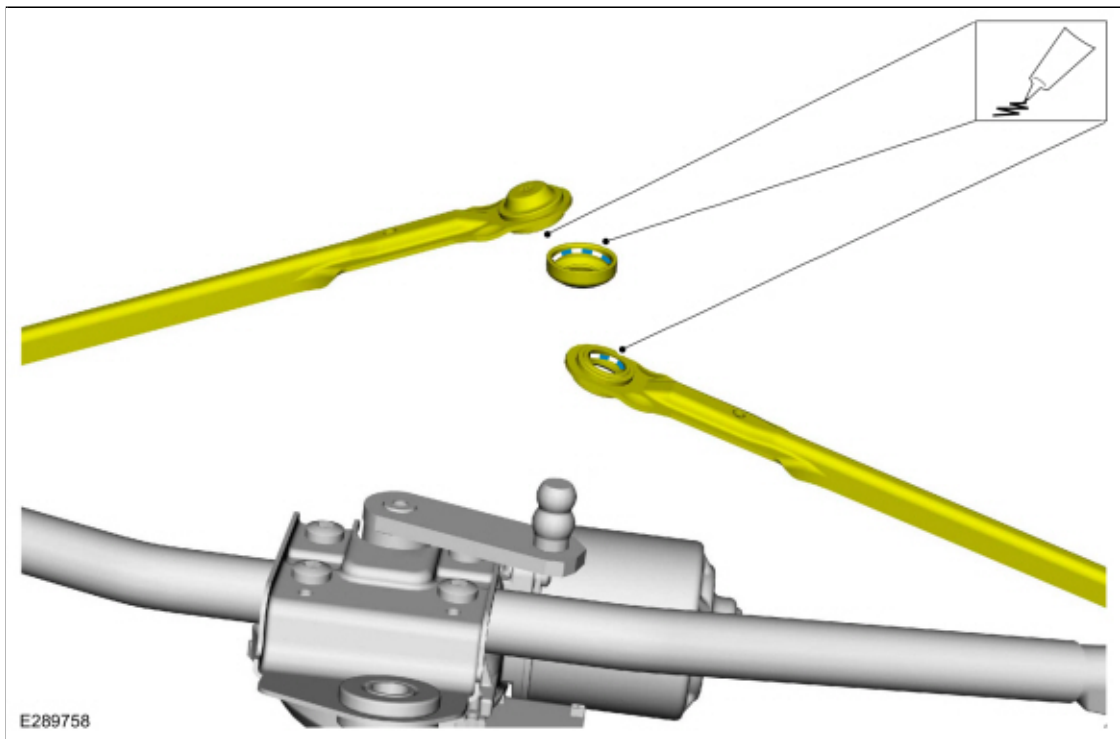

5.

1. Install the lower grease cup/seal.
2. Attach the LH windshield wiper link to the windshield wiper motor crank.
3. Install the new grease cover.
4. **NOTE:** Make sure the ball socket is properly assembled to the upper ball stud.

Attach the RH windshield wiper link to the windshield wiper motor crank.

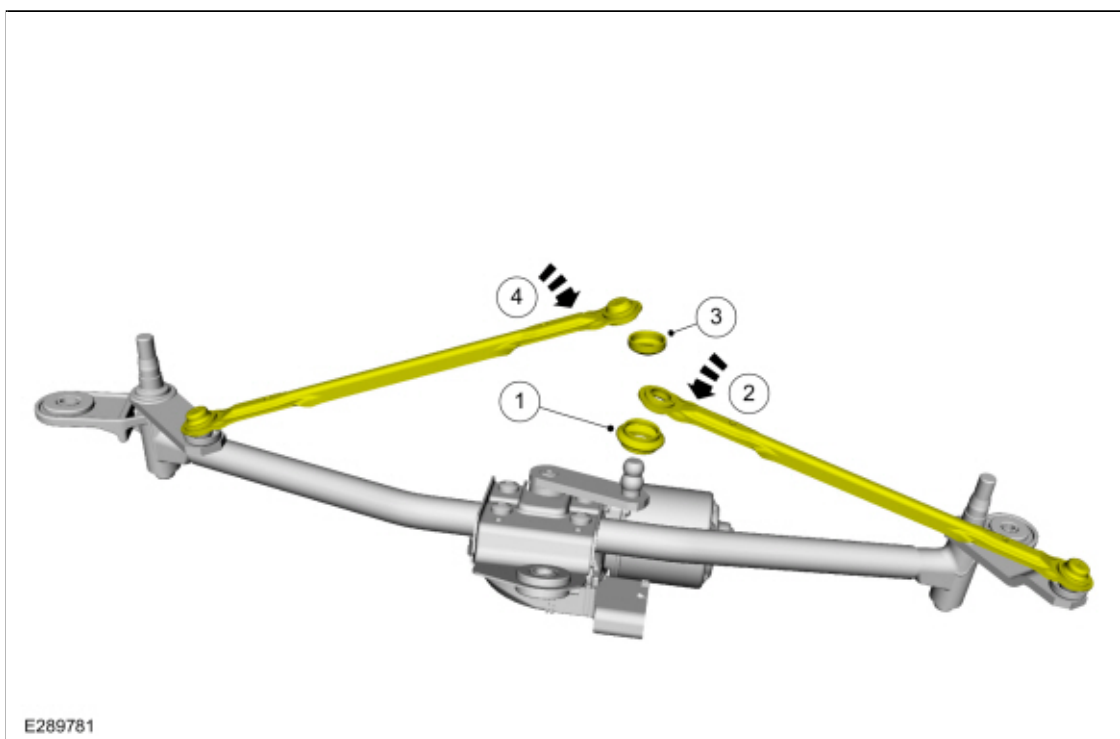

6. Install the wiper linkage assembly.

Refer to: [Wiper Linkage Assembly](#) (501-16 Wipers and Washers, Removal and Installation).

Copyright © 2019 Ford Motor Company

---