

Planetary Assembly

Planetary Gearset Exploded View

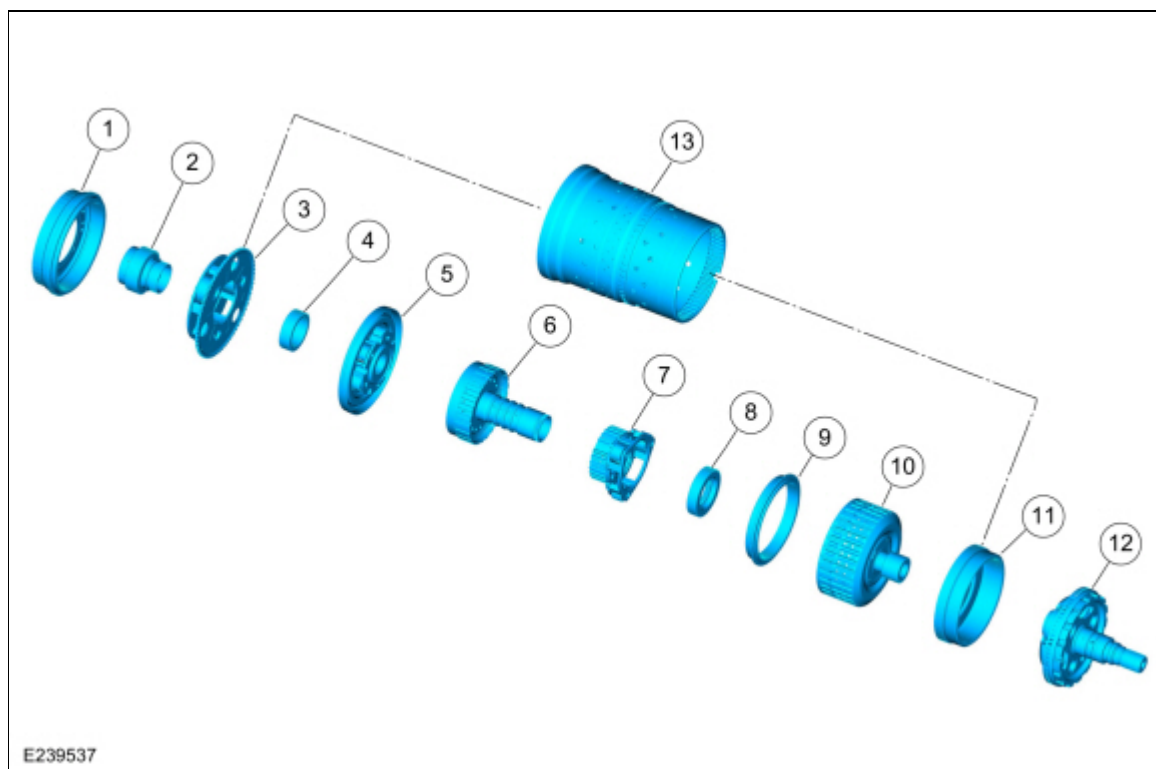

Item	Description
1	Ring gear No. 1
2	Sun gear No. 1
3	Planetary carrier No. 1
4	Sun gear No. 2
5	Planetary carrier No. 2
6	Ring gear No. 2
7	Planetary carrier No. 3
8	Sun gear No. 3
9	Ring gear No. 3
10	Shell and sun gear No. 4
11	Ring gear No. 4
12	Output shaft and planetary carrier No. 4 assembly

The 10R80 transmission has 4 planetary gear sets. Each gear set consists of a ring gear, a sun gear and a carrier. The gear sets are numbered 1 thru 4, from the front to the back of the transmission. There are several direct connections between the gear sets:

- Sun gears No. 1&2 are directly connected together with gear splines.
- Planetary carrier No. 1 and ring gear No. 4 are directly connected together with the cylinder (clutch and planetary container).
- Ring gear No. 2 and sun gear No. 3 are directly connected together with a shaft.
- Ring gear No. 3 and shell and sun gear No. 4 are directly connected together through the shell of the shell and sun gear No. 4.

Copyright © 2019 Ford Motor Company
