

C Clutch

Overview

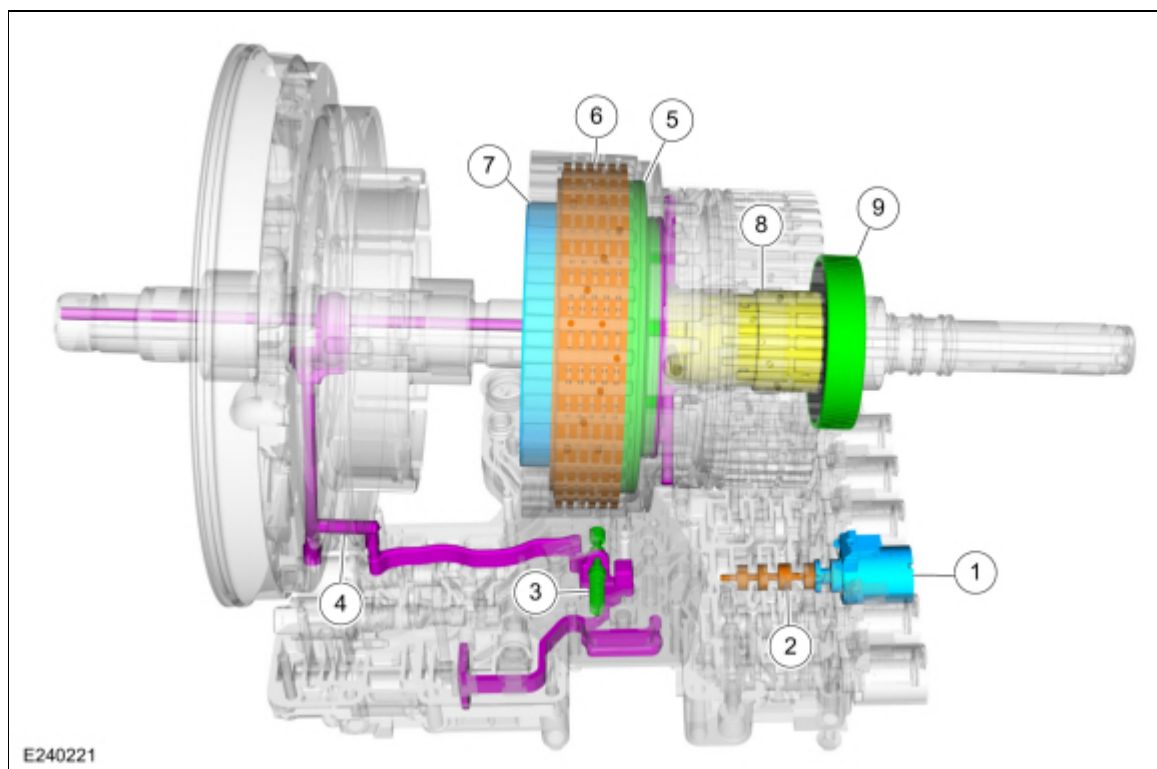

Item	Description
1	<u>SSC</u>
2	C clutch control valve
3	C clutch latch valve
4	C clutch apply circuit
5	C clutch piston
6	C clutch assembly
7	Ring gear No. 2
8	Shaft (sun gear No. 3)
9	Sun gear No. 3

Ring gear No. 2 is mechanically connected to sun gear No. 3 and is also connected to the C clutch. When the C clutch applies, torque from ring gear No. 2 may be applied the planetary carrier No. 3.

C Clutch Exploded View

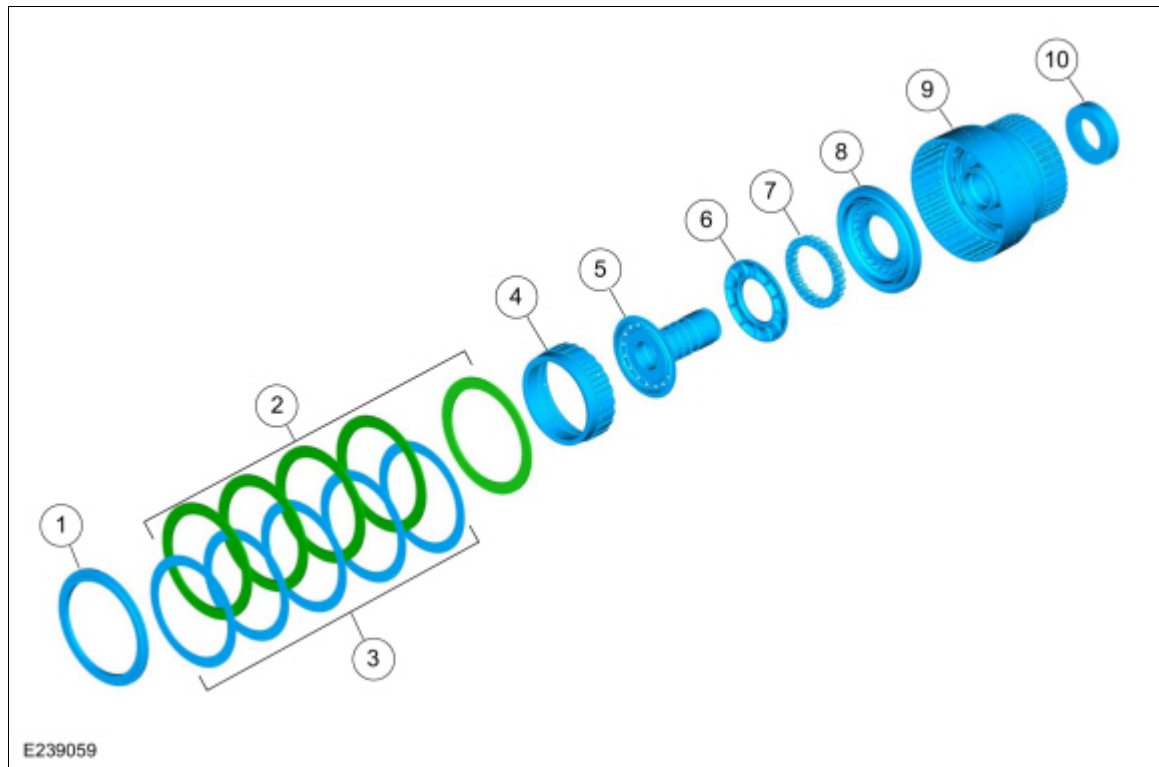

Item	Description
1	C clutch pressure plate
2	C clutch steel plates
3	C clutch friction plates
4	Ring gear No. 2
5	Shaft (sun gear No 3)
6	C clutch balance dam
7	C clutch piston return spring
8	C clutch piston
9	CDF clutch cylinder
10	Sun gear No. 3

C Clutch Hydraulic Circuits

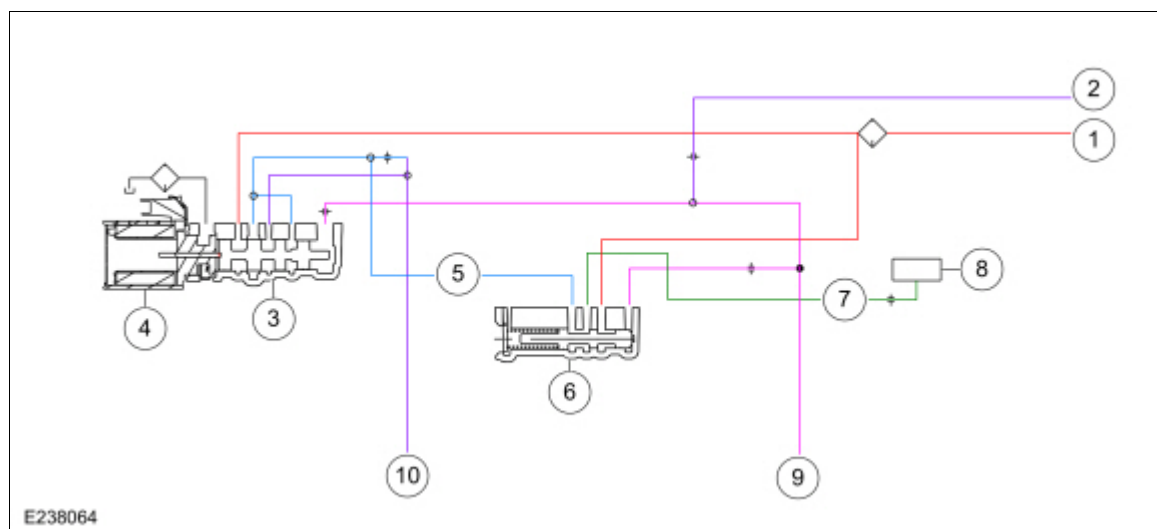

Item	Description
1	Line pressure
2	Pump output
3	C clutch control valve
4	<u>SSC</u>
5	Control pressure to latch valve
6	C clutch latch valve
7	Apply pressure to mechanical C clutch
8	Mechanical C clutch
9	Elevated exhaust pressure
10	Clutch exhaust

C Clutch Hydraulic Operation

Line pressure is supplied to the C clutch control valve and the C clutch latch valve. As SSC turns on, it moves the control valve allowing regulated line pressure to flow to the C clutch latch valve and then to the mechanical C clutch. When the regulated line pressure in the C clutch control circuit reaches approximately 100 psi, the mechanical C clutch is fully applied. The pressure in the C clutch control circuit moves the C clutch latch valve to the left which allows line pressure to hold the mechanical C clutch applied.

C Clutch Hydraulic Passages

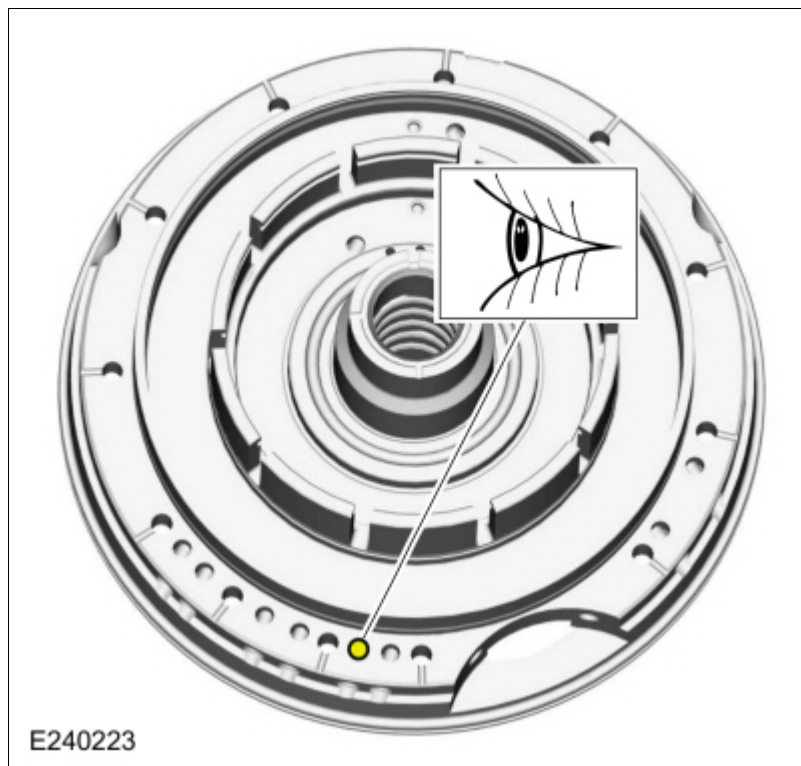
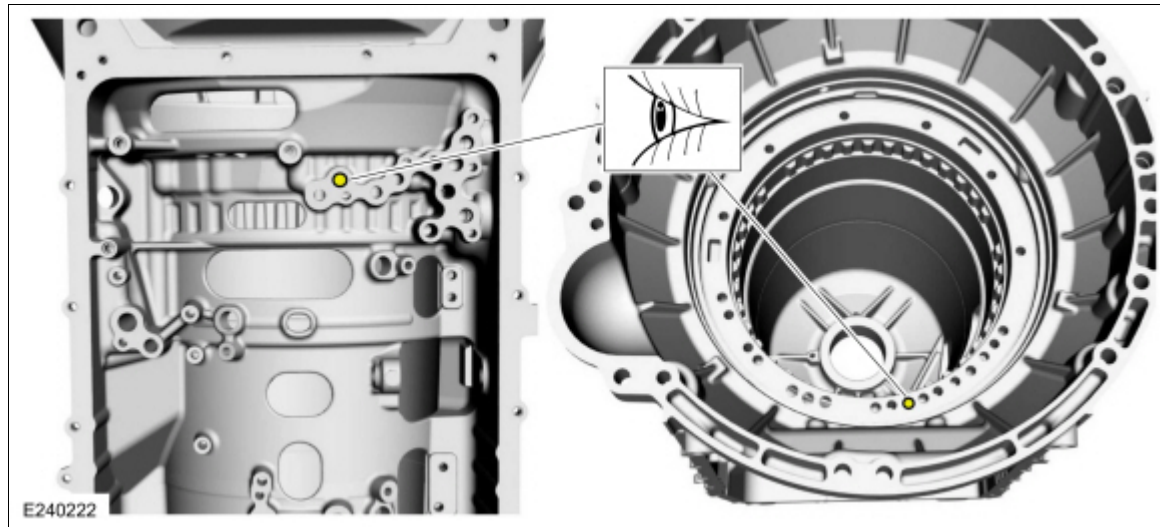

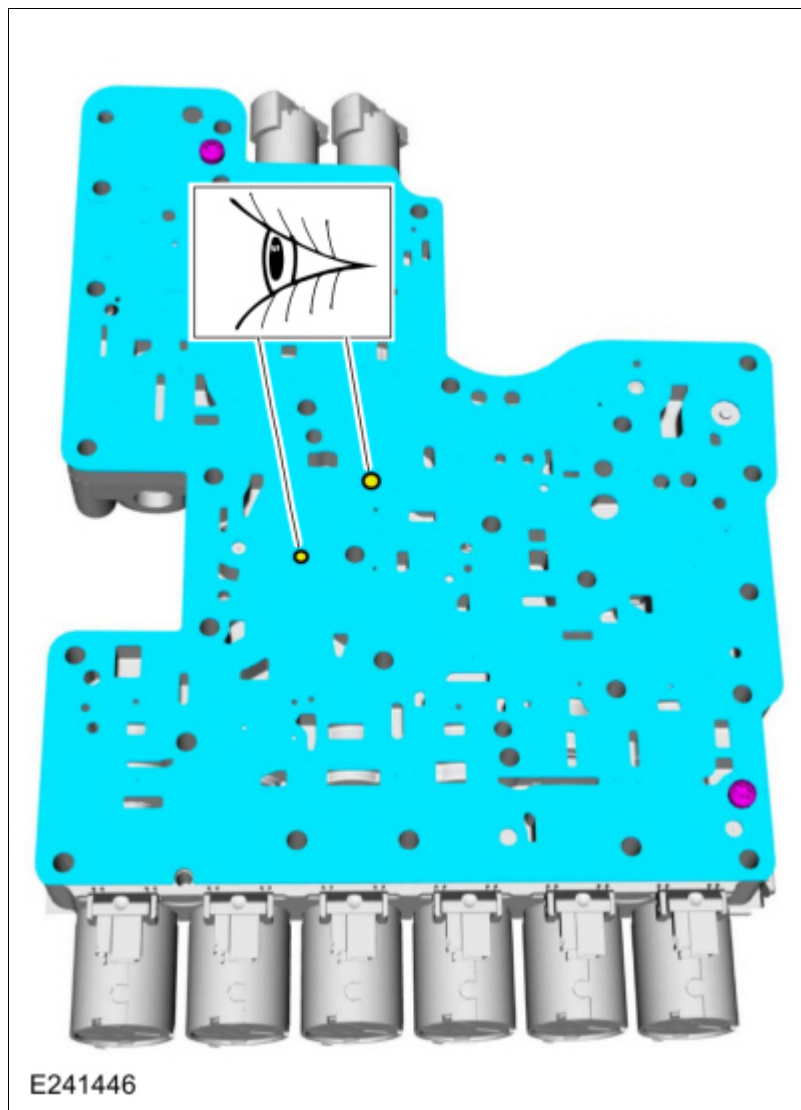
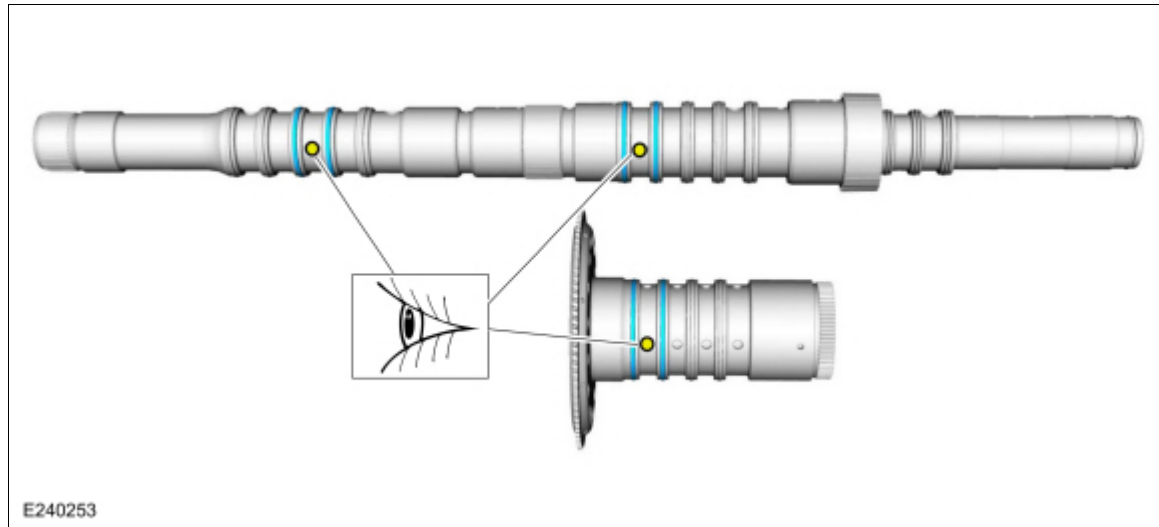

Copyright © 2019 Ford Motor Company

