

Anti-Lock Brake System (ABS) Module

Base Part Number: 2C219

Removal

NOTE: Removal steps in this procedure may contain installation details.

1. **NOTE:** The PMI process must begin with the current ABS module installed. If the current ABS module does not respond to the diagnostic scan tool, the tool may prompt for As-Built Data as part of the repair.

Using a diagnostic scan tool, begin the PMI process for the ABS module following the onscreen instructions.

2. Remove the HCU
Refer to: [Hydraulic Control Unit \(HCU\)](#) (206-09 Anti-Lock Brake System (ABS) and Stability Control, Removal and Installation).
3. **NOTICE:** Make sure the HCU and ABS module are clean and free of brake fluid or foreign material before separating the components. Do not allow any brake fluid or foreign material to enter the mating side of the ABS module or component damage can occur.

Remove the screws and the ABS module.
Torque: 53 lb.in (6 Nm)

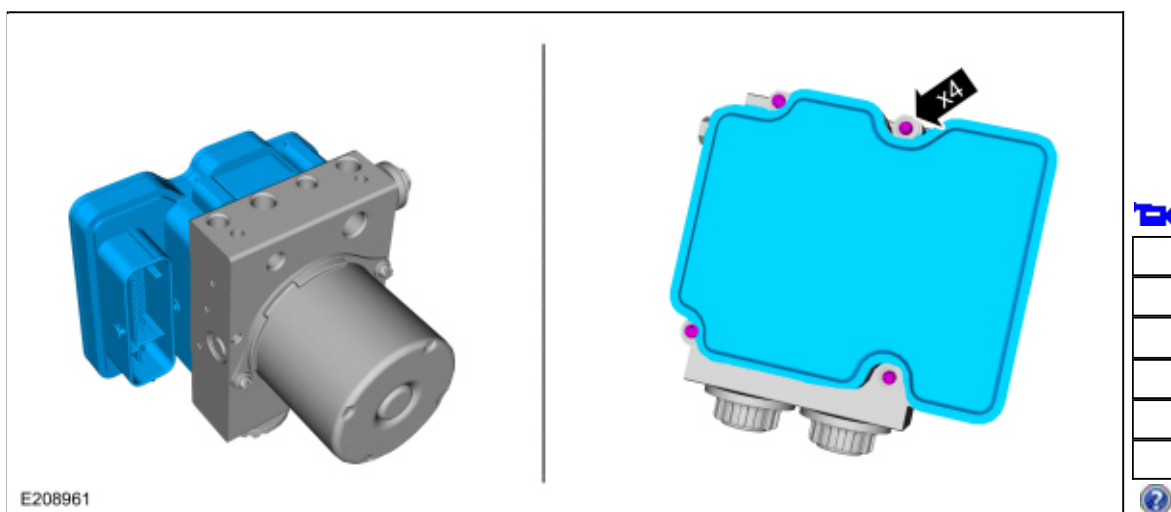

Installation

1. To install, reverse the removal procedure.
2. Using a diagnostic scan tool, complete the PMI process for the ABS module following the on-screen instructions.
3. Carry out the IVD initialization using the scan tool and following the diagnostic scan tool on-screen

instructions.

Copyright © 2019 Ford Motor Company
