

Brake Pedal and Bracket

Base Part Number: 2455

Removal

NOTICE: Do not service the brake pedal or brake booster without first removing the stoplamp switch. This switch must be removed with the brake pedal in the at-rest position. The switch plunger must be compressed for the switch to rotate in the bracket. Attempting to remove the switch when the plunger is extended (during pedal apply) will result in damage to the switch.

NOTE: Removal steps in this procedure may contain installation details.

1. Disconnect the stop-lamp switch electrical connector.

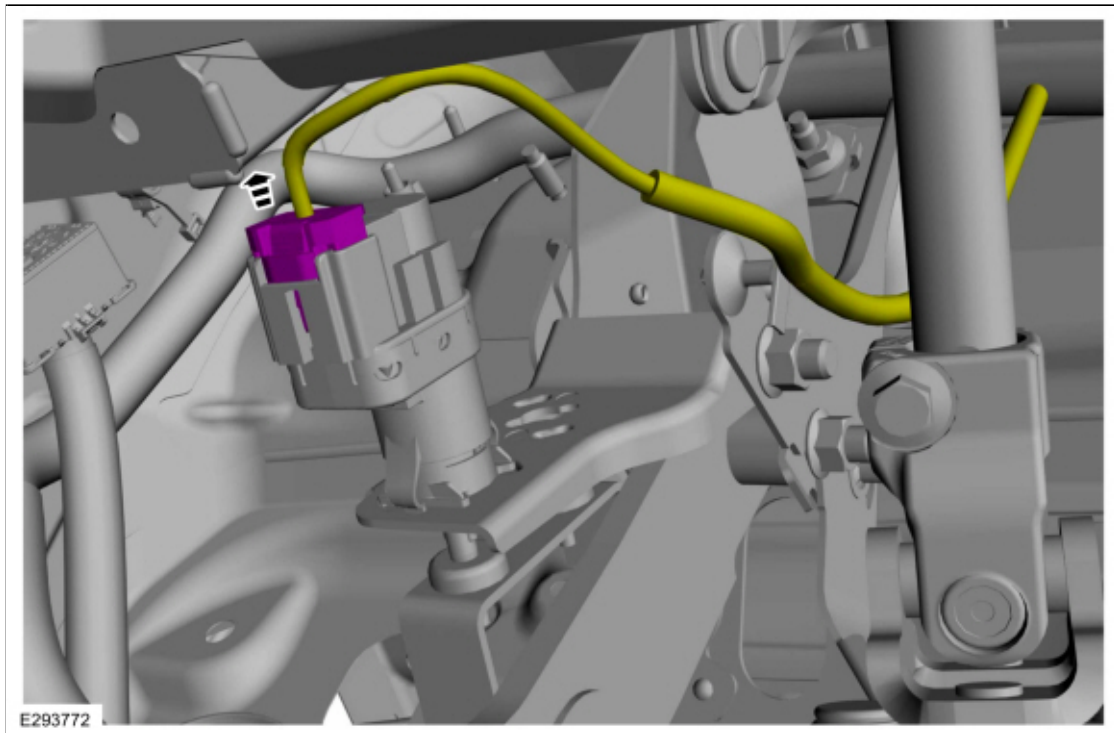

2. Turn the stoplamp switch clock-wise and remove the switch.

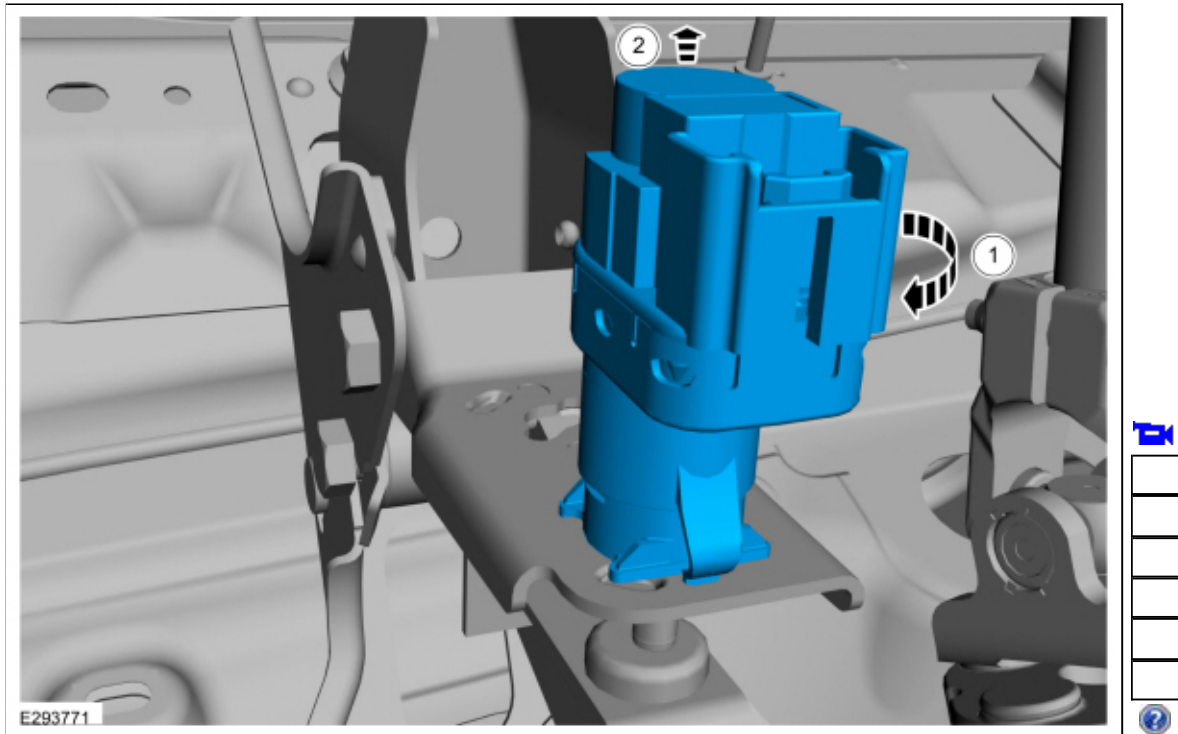

3. Remove and discard the lock pin assembly.

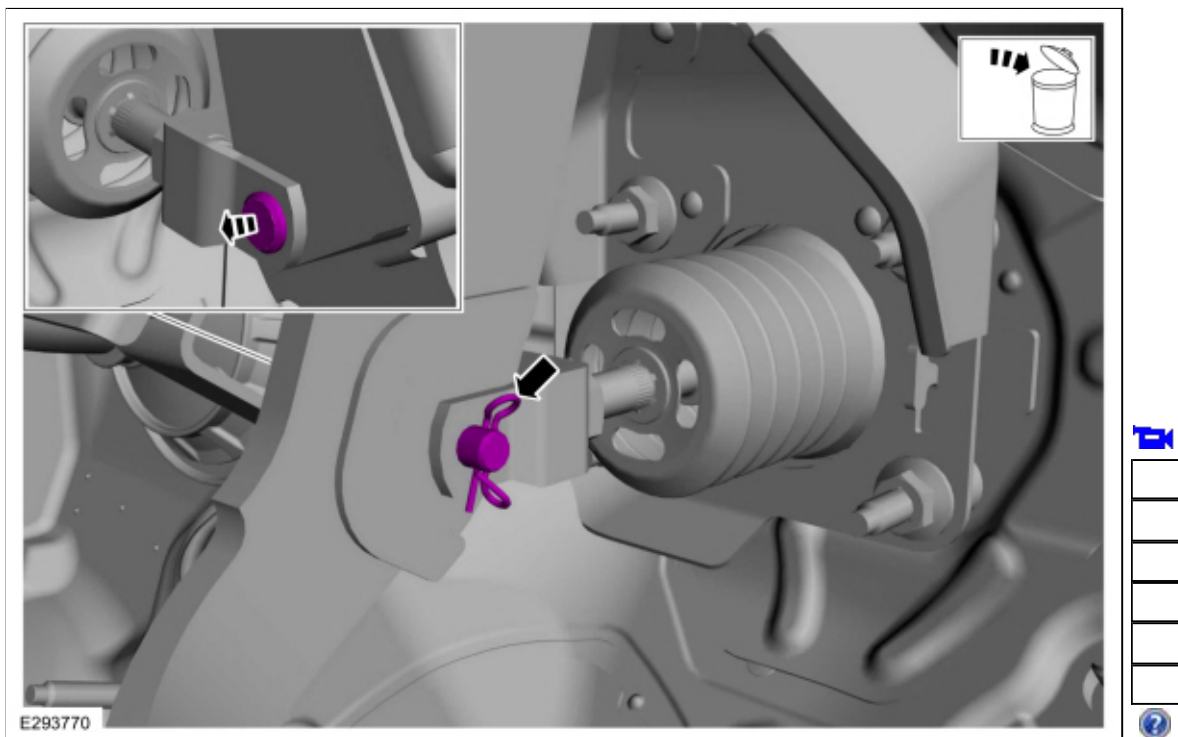

4. Remove the nuts and remove the brake pedal and bracket.
Torque: 133 lb.in (15 Nm)

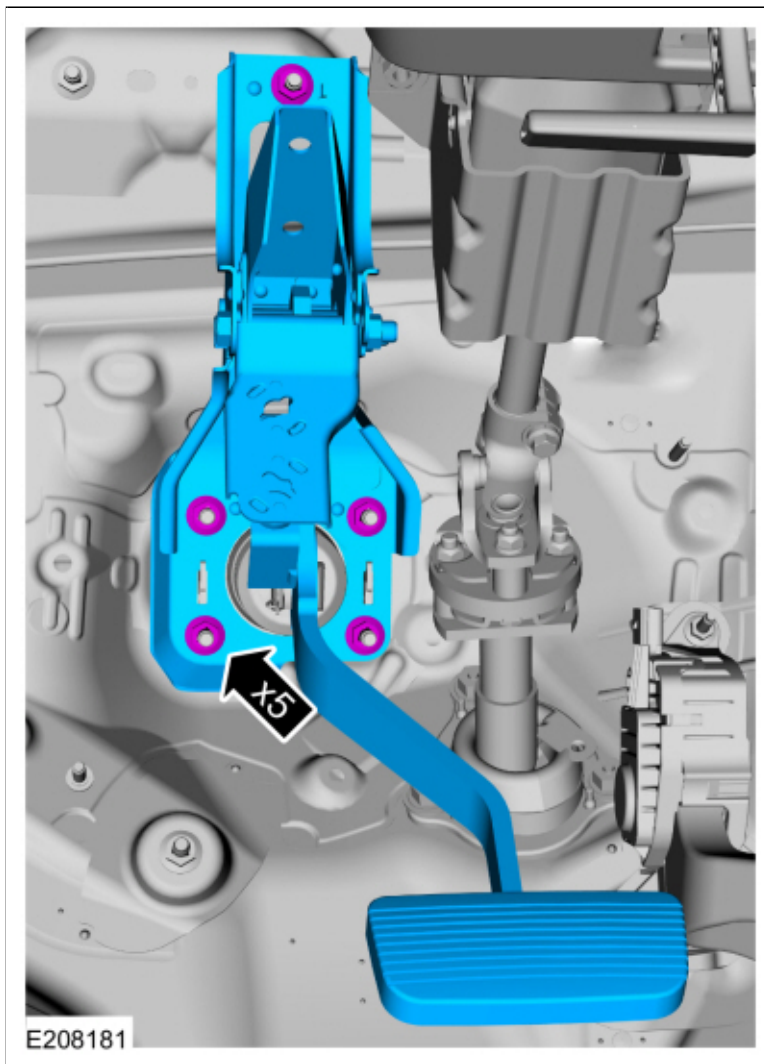

Installation

1. **NOTICE:** Make sure that the brake booster push rod is correctly located.

NOTICE: An incorrectly set Stop Lamp Switch causes either over-heating brakes in the case of the pedal being pushed down or ABS faults in the case of it being lifted during Stop Lamp Switch installation. To avoid damages to the brake system, remove the Stop Lamp Switch and install with the brake pedal in neutral position.

To install, reverse the removal procedure.

Copyright © 2019 Ford Motor Company

