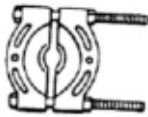

205-01 Driveshaft  
Removal and Installation

2019 Ranger  
Procedure revision date: 10/26/2018

### Driveshaft Center Bearing

#### Special Tool(s) / General Equipment

	<a href="#">205-495</a> Installer, Transmission Output Shaft Flange
	<a href="#">205-D064</a> (D84L-1123-A) Puller, Bearing
Hydraulic Press	
Two Leg Puller	

#### Removal

1. Remove the driveshaft universal joint.  
Refer to: [Driveshaft Universal Joint](#) (205-01 Driveshaft, Disassembly and Assembly).
2. Remove and discard the driveshaft yoke nut and washer.

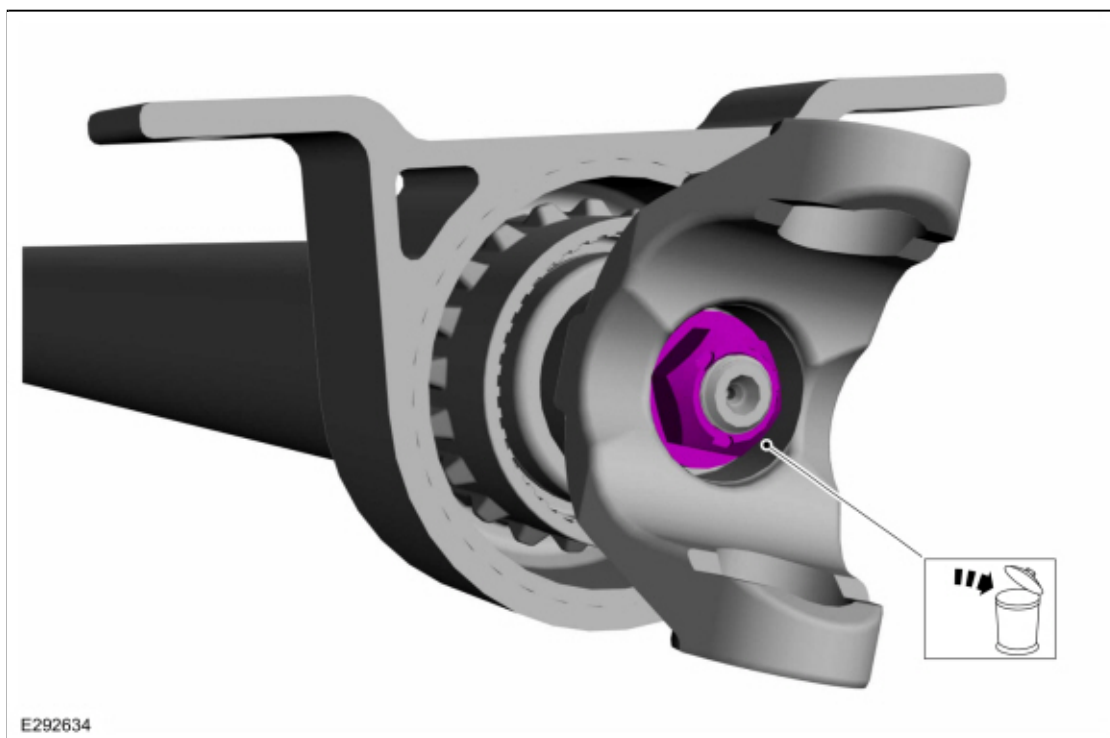

3. **NOTE:** The driveshaft yoke need to be installed in the same location as removed.

Index-mark splines on the stub shaft and a corresponding spline on the yoke.

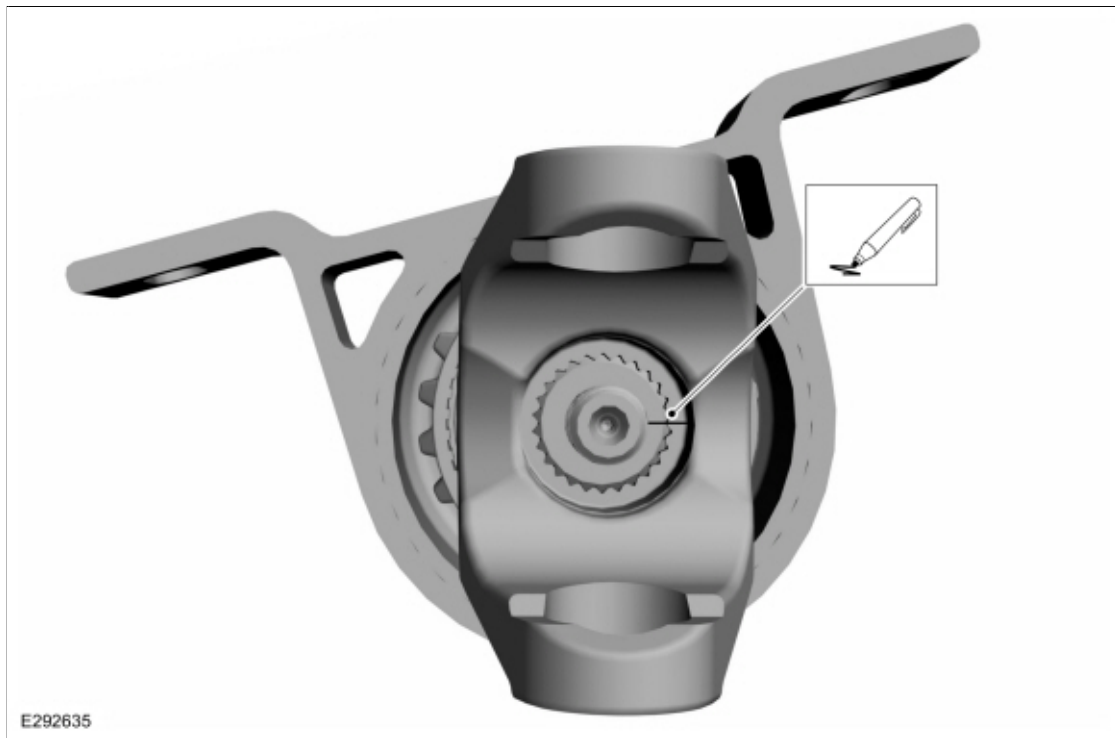

4. **NOTICE:** The driveshaft yoke fits tightly on stub shaft. Never hammer on the yoke or any of its components to disconnect the yoke from the stub shaft.

Using a general equipment, remove the rear driveshaft yoke.  
Use the General Equipment: Two Leg Puller

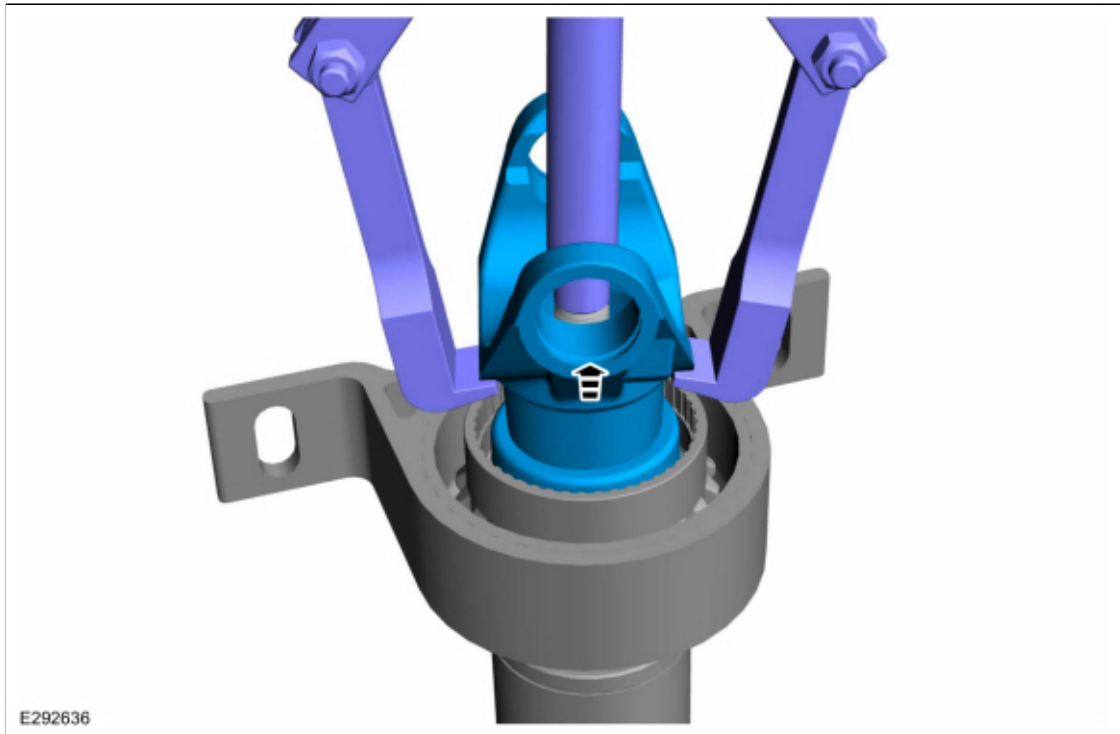

5. **NOTICE:** Take extra care not to damage the component.

Install the special tool under the center bearing.

Use Special Service Tool: [205-D064 \(D84L-1123-A\) Puller, Bearing.](#)

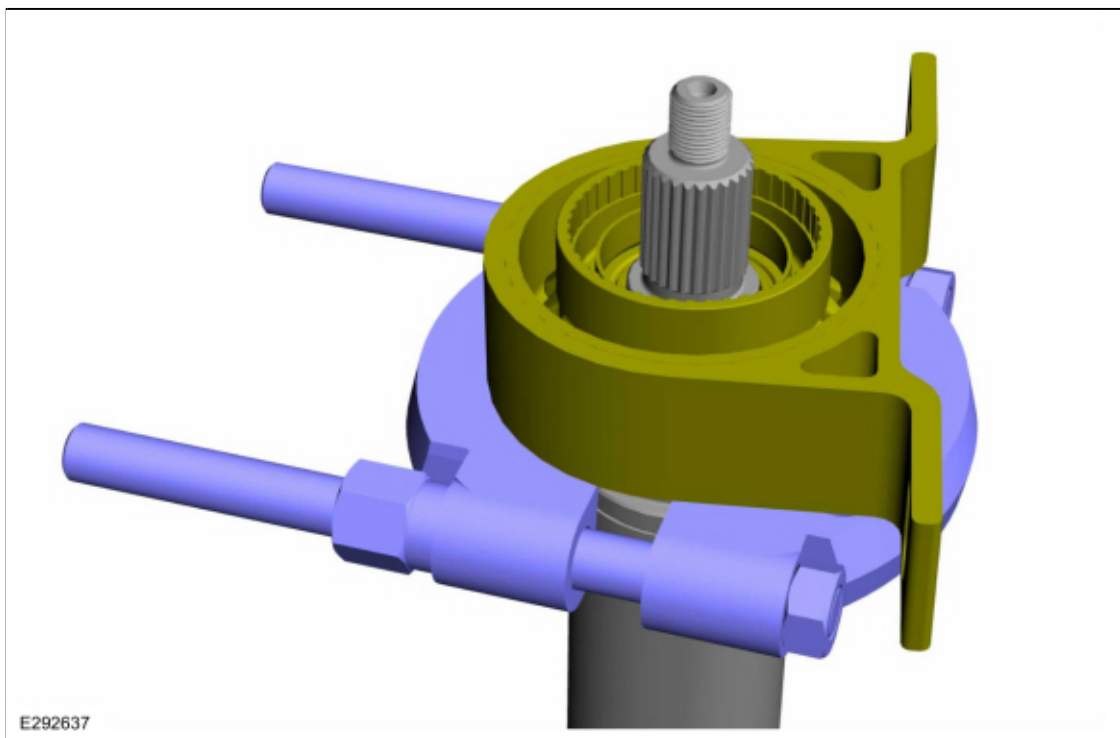

6. Using the special tool, remove the center bearing from driveshaft.

Use Special Service Tool: [205-D064 \(D84L-1123-A\) Puller, Bearing.](#)  
 Use the General Equipment: Two Leg Puller

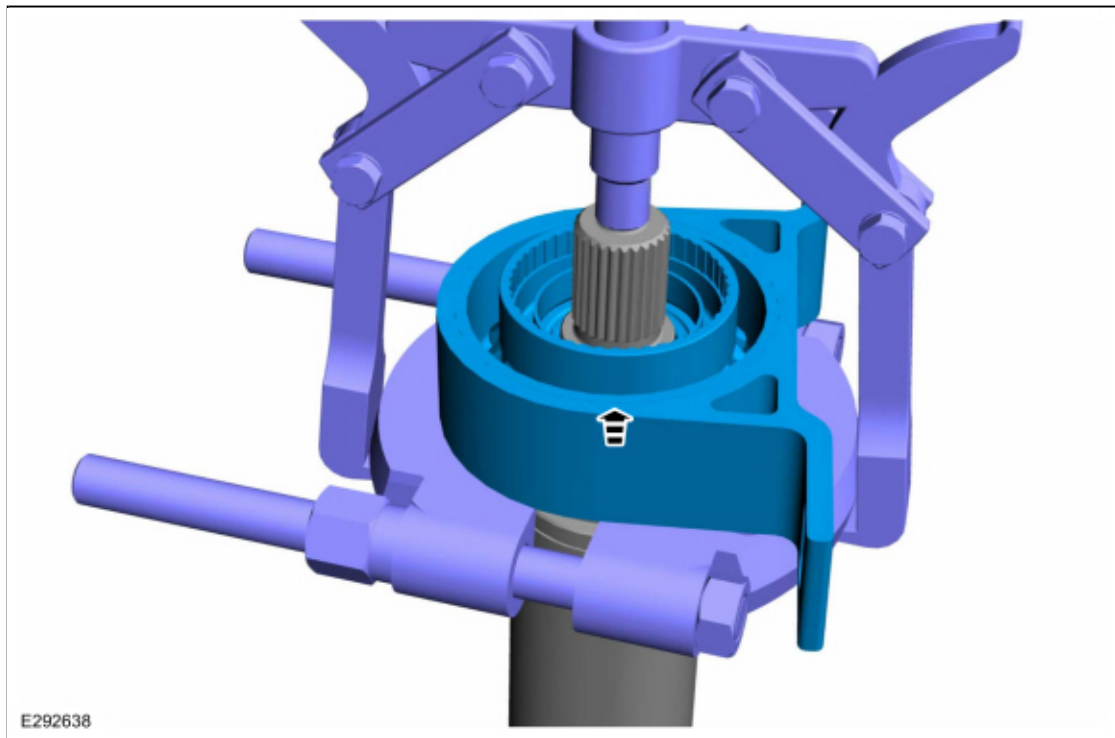

7. Using a general equipment, remove the centre bearing dust cap from the driveshaft.  
 Use Special Service Tool: [205-D064 \(D84L-1123-A\) Puller, Bearing.](#)  
 Use the General Equipment: Two Leg Puller

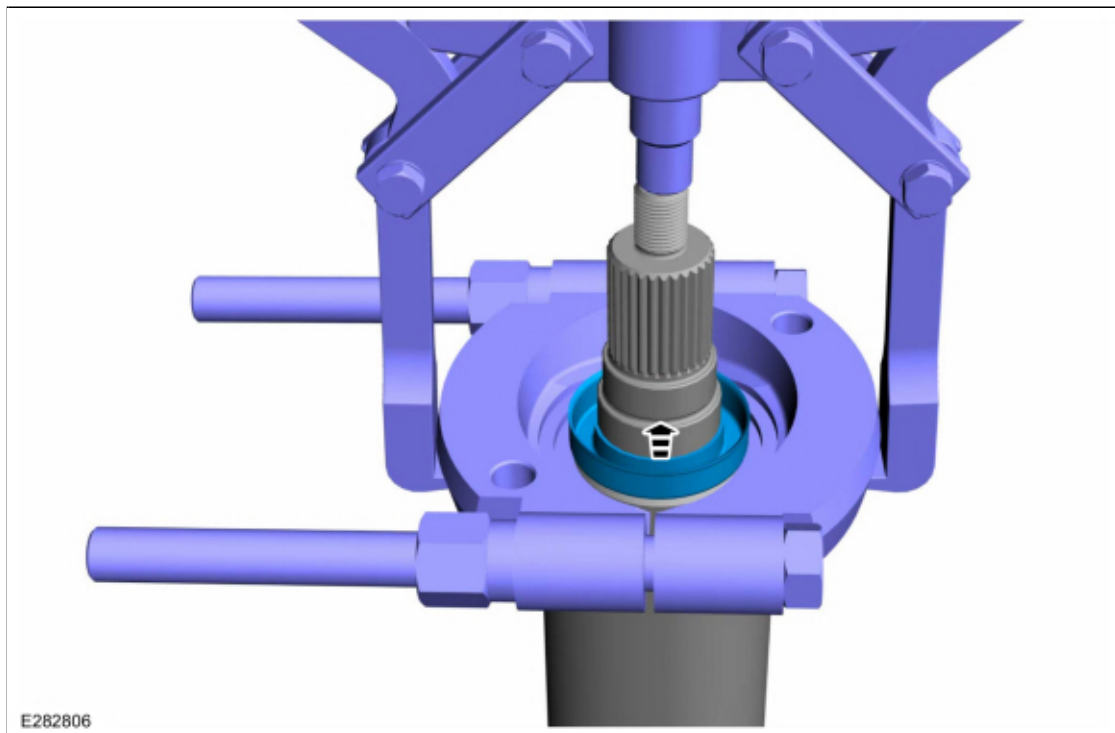

8. Clean the center bearing mating surface.

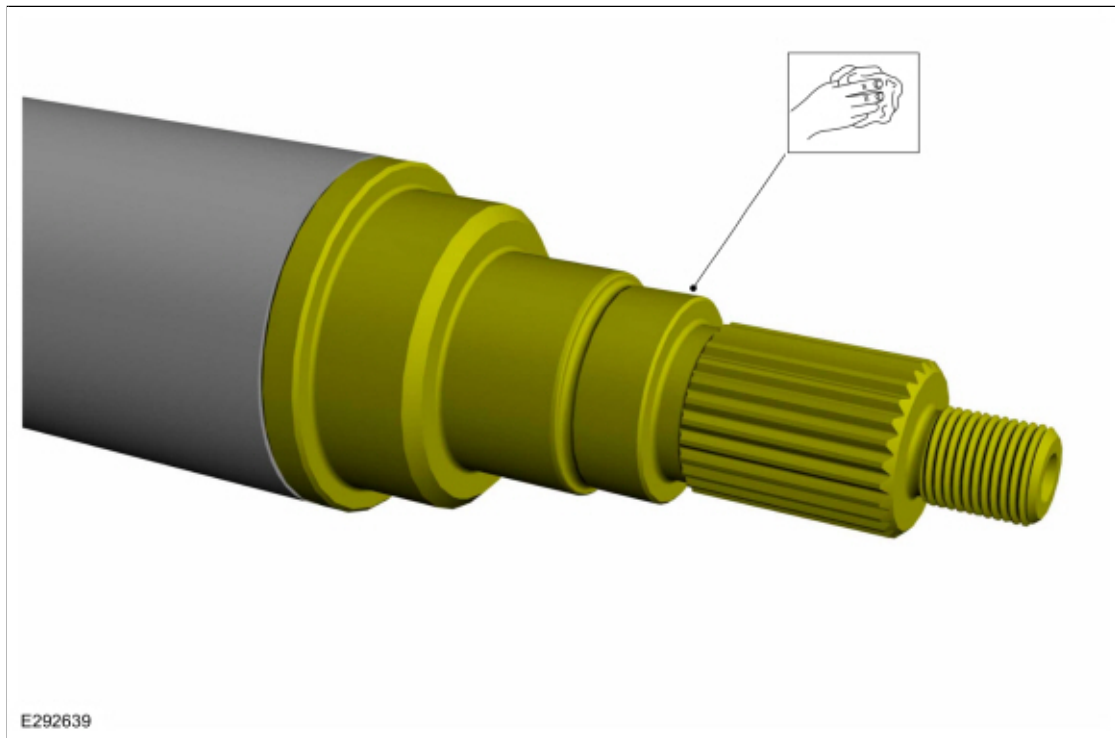

### Installation

1. **NOTE:** Make sure the driveshaft center bearing dust cap is seated correctly or damage to the components may occur.

Install the center bearing dust cap on to the driveshaft.

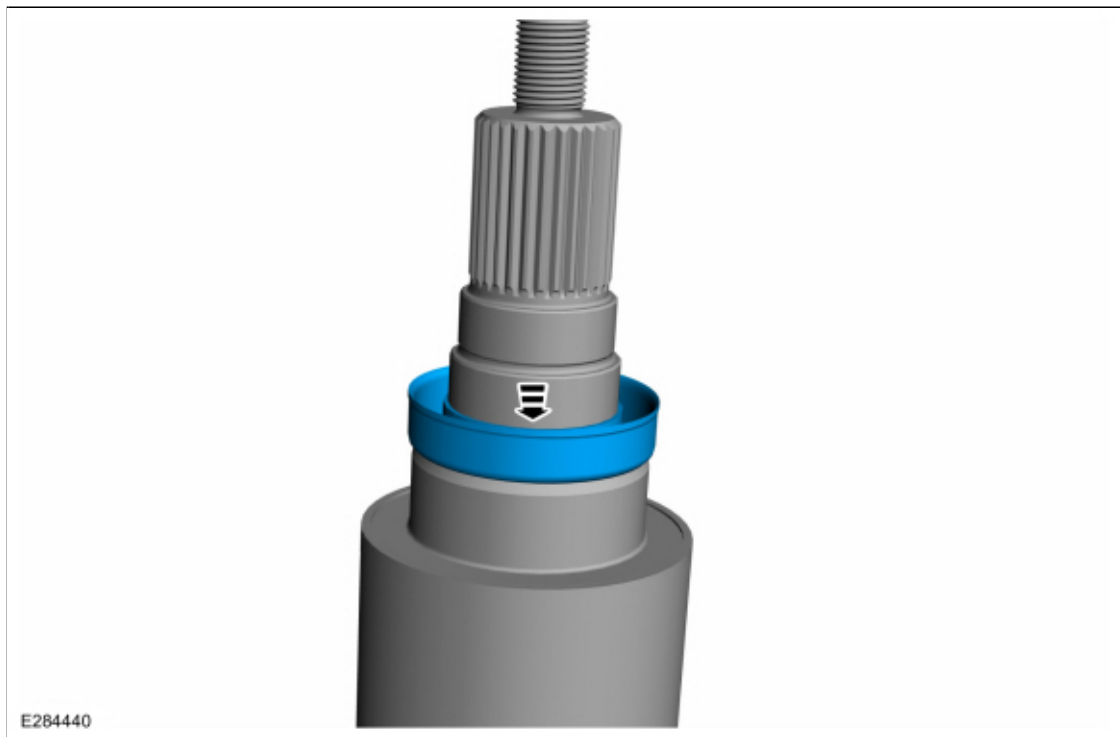

2. **NOTE:** *The center bearing is serviced as a complete assembly, therefore separating the U-shaped bracket from the rubber cushion is not required.*

Position the center bearing on to the driveshaft.

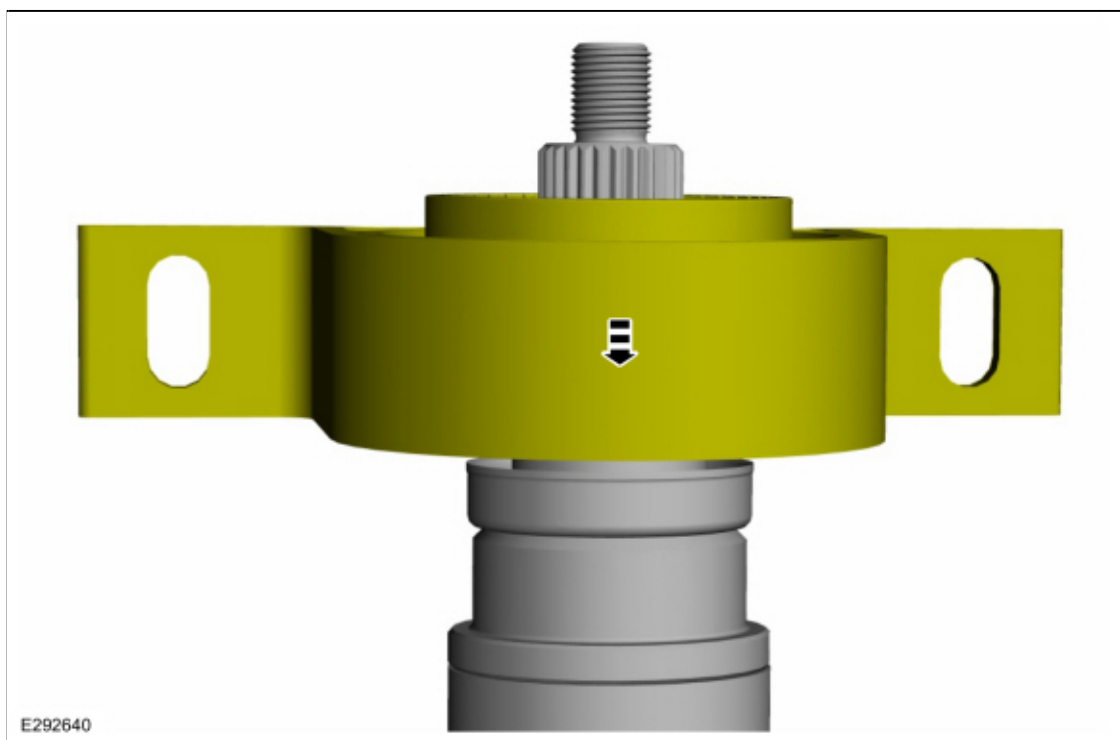

3. Using the special tool, install the center bearing on to the driveshaft.

Use Special Service Tool: [205-495 Installer, Transmission Output Shaft Flange](#).  
Use the General Equipment: Hydraulic Press

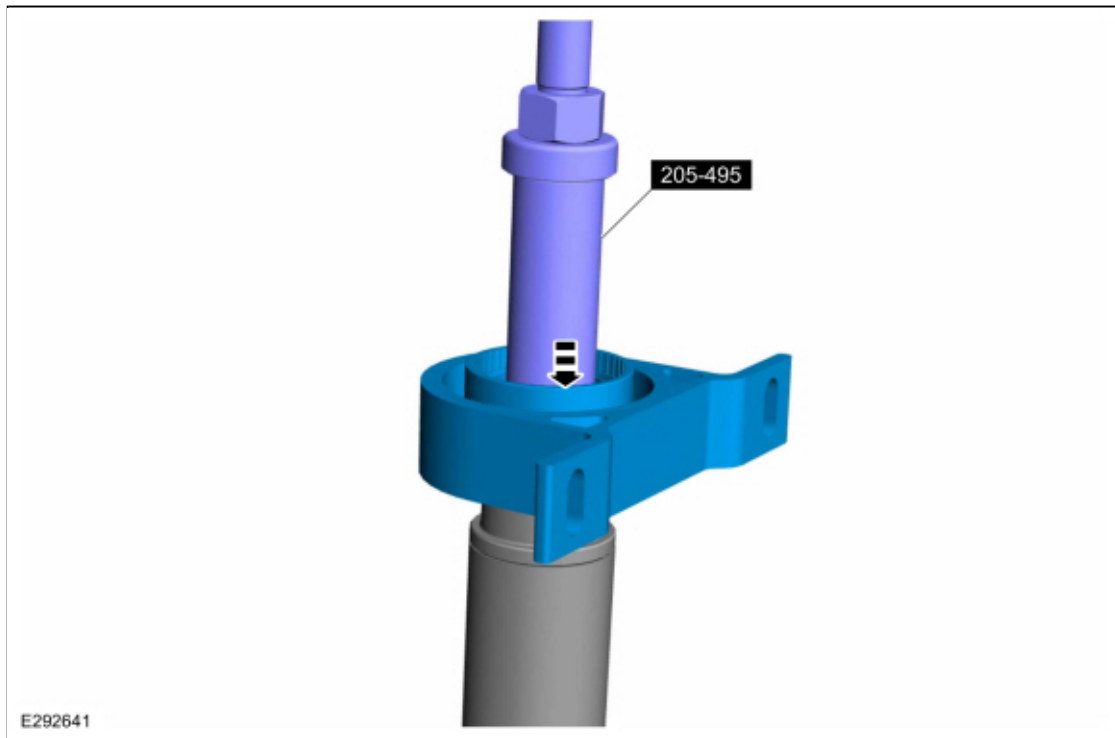

4. **NOTE:** Push the yoke on the driveshaft as far as possible by hand.

**NOTE:** Make sure yoke and stub shaft are phased correctly using previously applied mark.

Install the driveshaft yoke.

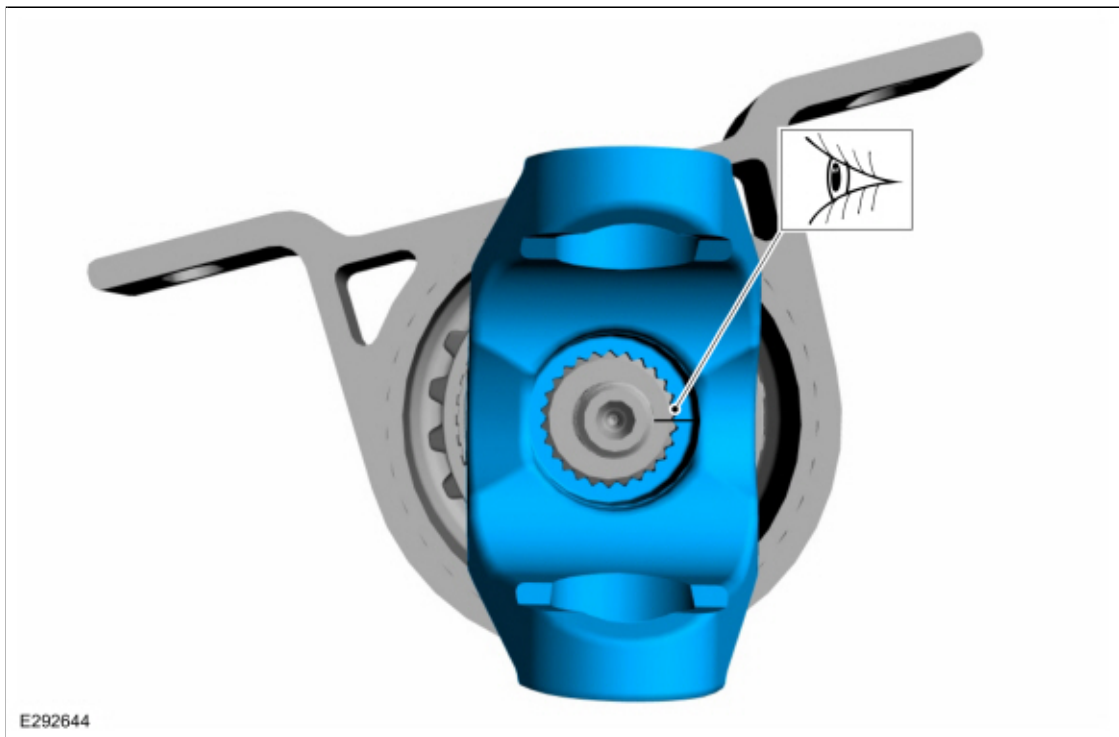

5. **NOTE:** *Install the old nut and washer and lightly tighten it to draw the yoke into proper position.*

Install a new driveshaft yoke washer and nut.  
*Torque: 111 lb.ft (150 Nm)*

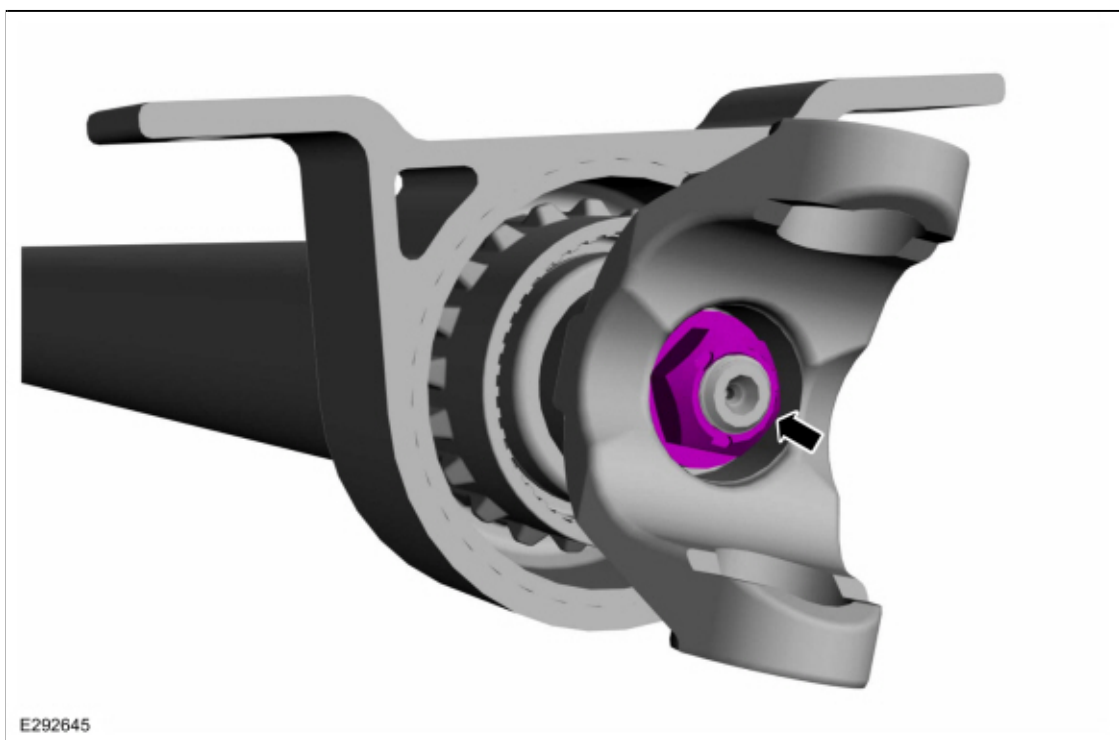

6. Install the driveshaft universal joint.



Refer to: [Driveshaft Universal Joint](#) (205-01 Driveshaft, Disassembly and Assembly).

Copyright © 2019 Ford Motor Company

---