

Front Strut and Spring Assembly

Base Part Number: 18045

Special Tool(s) / General Equipment

Spring Compressor
Vise

DISASSEMBLY

NOTICE: Suspension fasteners are critical parts that affect the performance of vital components and systems. Failure of these fasteners may result in major service expense. Use the same or equivalent parts if replacement is necessary. Do not use a replacement part of lesser quality or substitute design. Tighten fasteners as specified.

NOTE: Disassembly steps in this procedure may contain assembly details.

1. Remove the shock absorber and spring assembly.
Refer to: [Shock Absorber and Spring Assembly](#) (204-01A Front Suspension - RWD, Removal and Installation).
2.  **WARNING:** Coil springs and strut assemblies are compressed under extreme load. Always use a spring compressor for disassembly. Follow procedure instructions carefully and make sure the spring compressor has the correct spring plates or adapters. Failure to follow these instructions may result in serious personal injury..

NOTICE: When installing a suitable spring compressor, use care not to damage the spring coating.

NOTICE: Take extra care not to damage the component.

NOTICE: Do not use power tools to remove the nut.

NOTE: Typical assembly shown. actual application may vary.

- Compress the spring until the tension is released from the shock absorber.
Use the General Equipment: Spring Compressor
- Carefully remove and discard the strut rod nut and remove the upper cap.

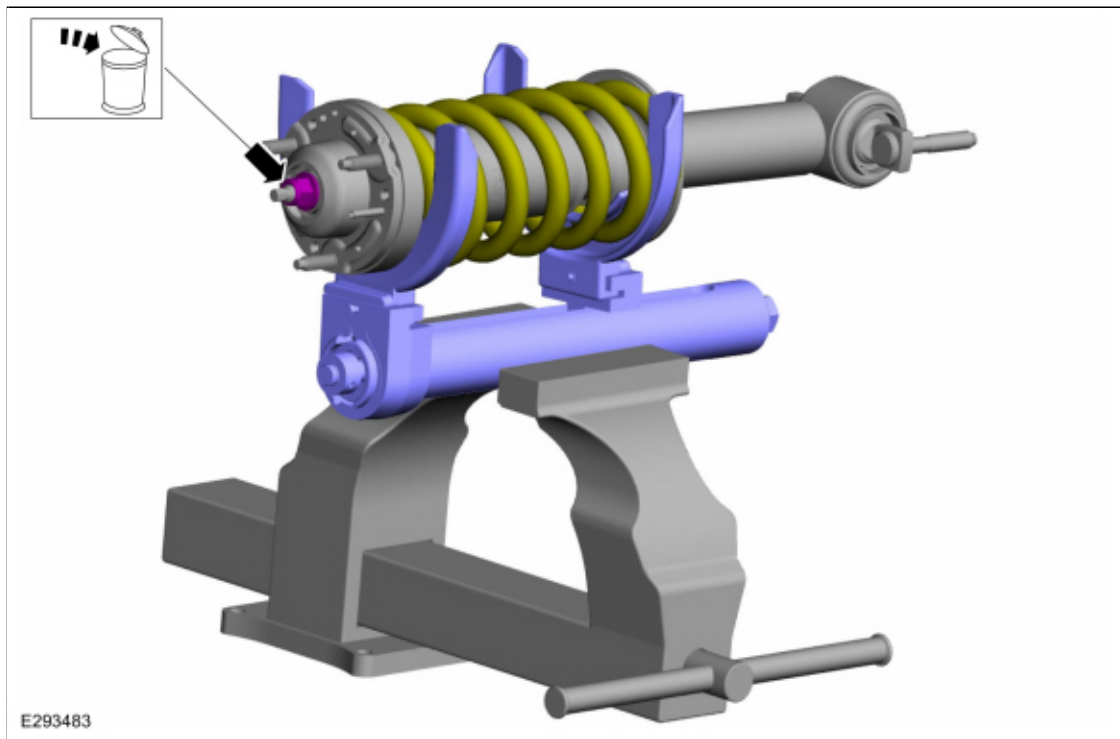

3. **NOTE:** Note the position of the component before removal.

Disassemble the front strut and spring assembly in the order shown.

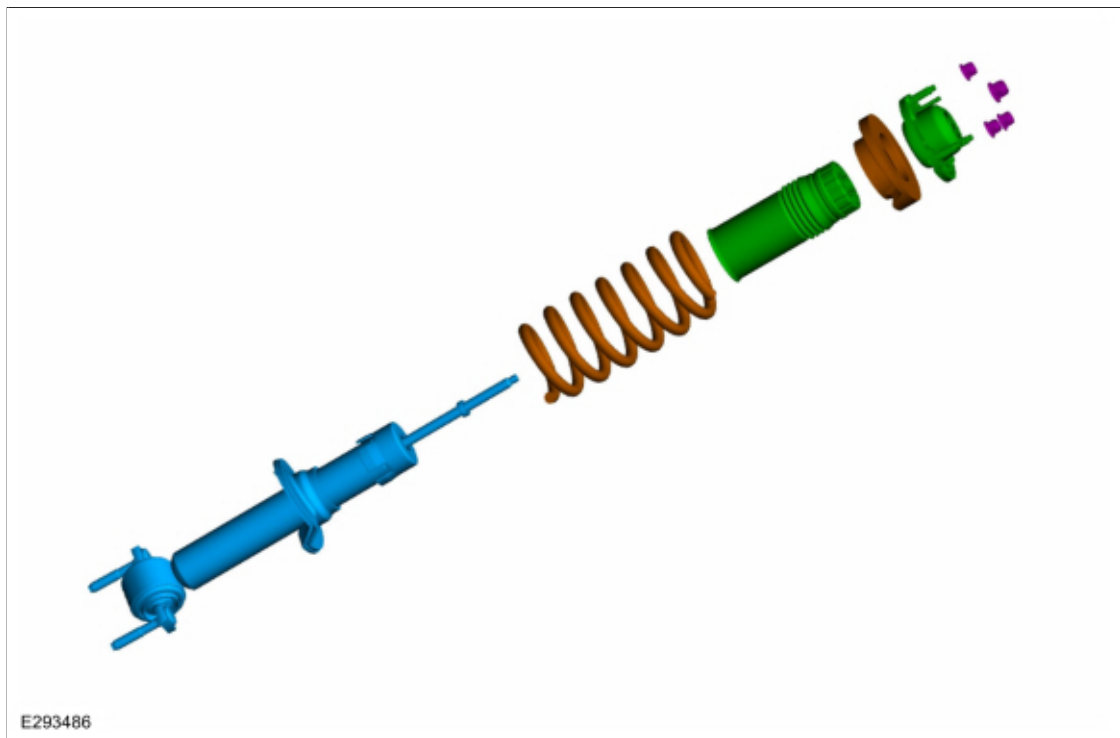

ASSEMBLY

1.  **WARNING:** Take extra care when handling a compressed spring. Failure to follow this instruction may result in personal injury.

To assemble, reverse the disassembly procedure.

2. **NOTE:** Use the hex-holding feature to prevent the strut rod from rotating while removing and installing the strut rod nut.

NOTE: Only tighten the nut finger tight at this stage.

Install the shock absorber and the upper mount.
 Use the General Equipment: Spring Compressor
 Use the General Equipment: Vise

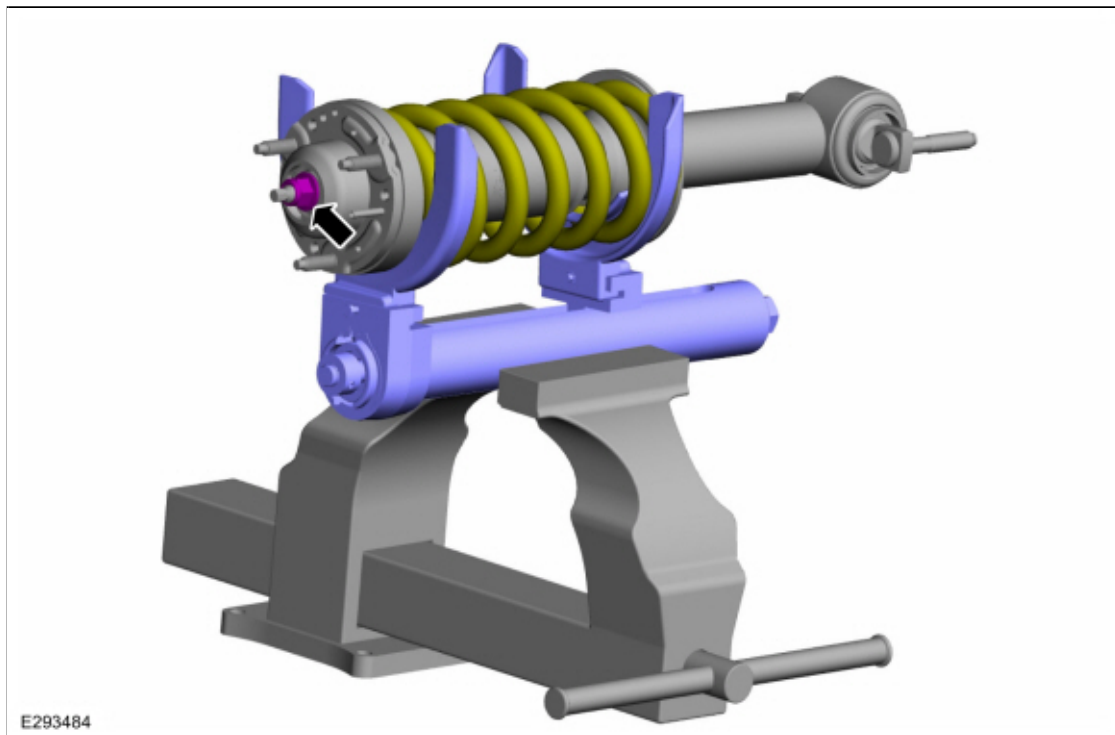

3. **NOTE:** Make sure that the spring coating is not damaged during assembly process.

NOTE: Make sure that the spring is not overcompressed during installation

NOTE: Make sure that the components are installed to the position noted before removal.

NOTE: Make sure the "ID Label" and paint dot is located at lower end of the installed coil spring.

Make sure that the lower spring seat is properly installed.
 Use the General Equipment: Spring Compressor

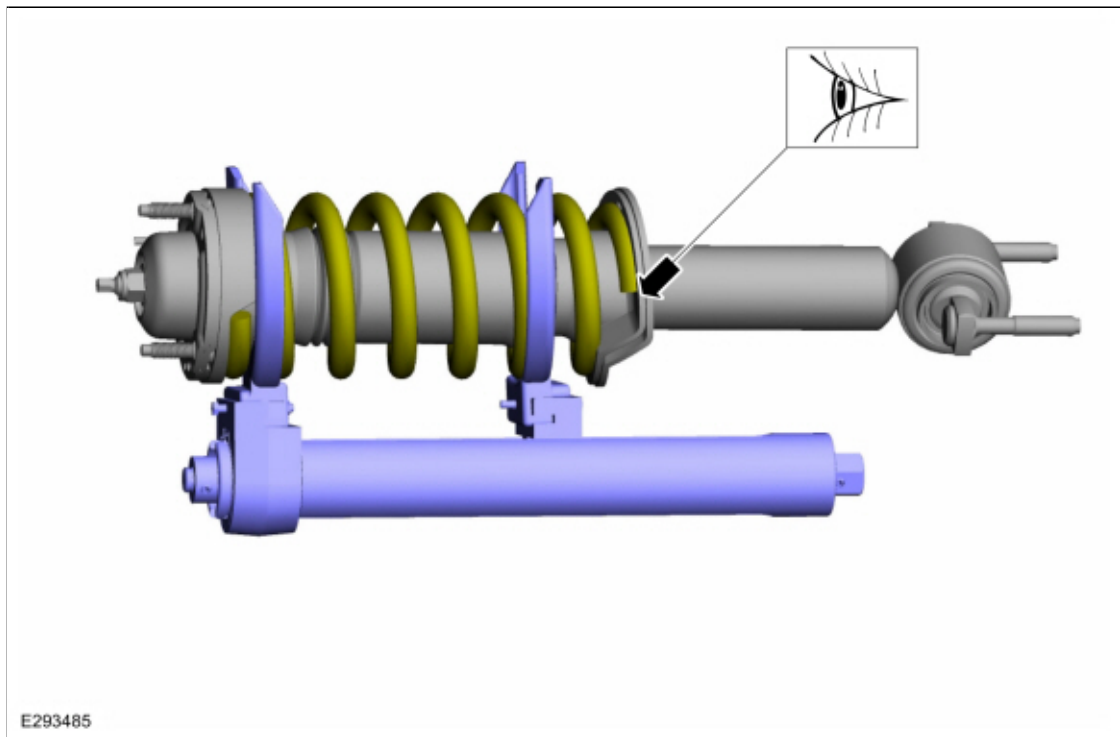

4.

1. Damper bush bottom axis .
Use the General Equipment: Spring Compressor
2. **NOTE:** Make sure that the correct tolerances are observed.

3. LH $4^{\circ} \pm 3^{\circ}$
RH $20^{\circ} \pm 3^{\circ}$

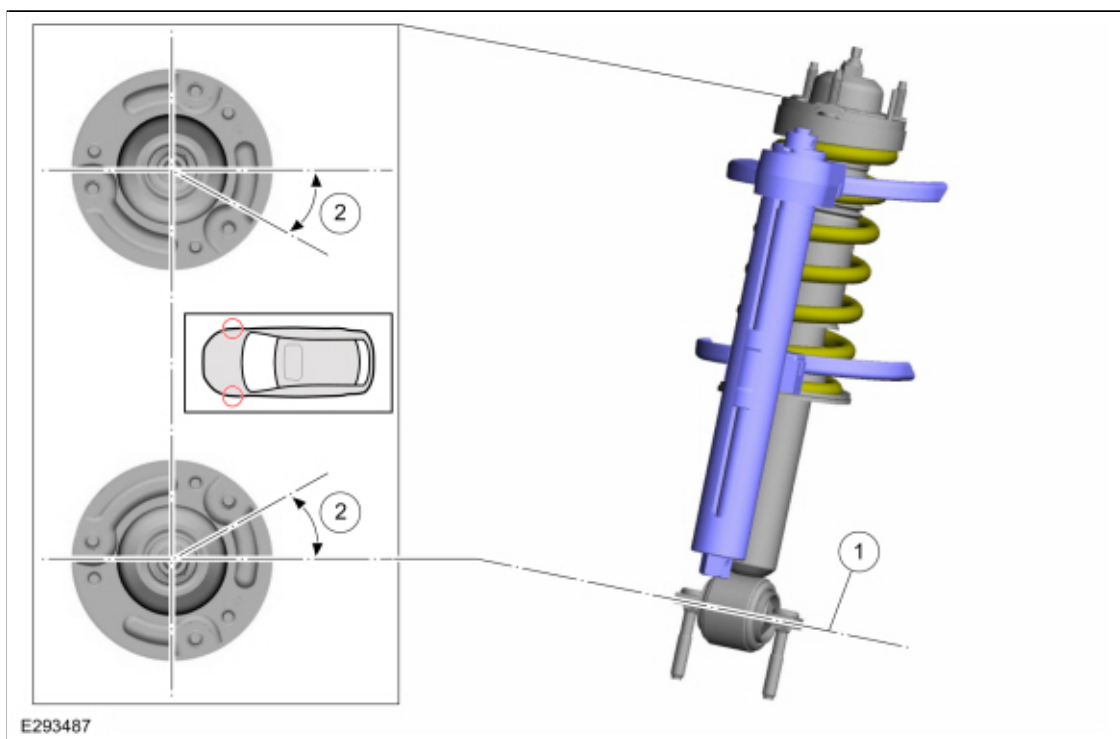

5. **NOTE:** Use the hex-holding feature to prevent the strut rod from rotating while removing and installing the strut rod nut.

While holding the shock rod, install the new shock absorber and the shock rod nut.

Use the General Equipment: Spring Compressor

Use the General Equipment: Vise

Torque: 41 lb.ft (55 Nm)

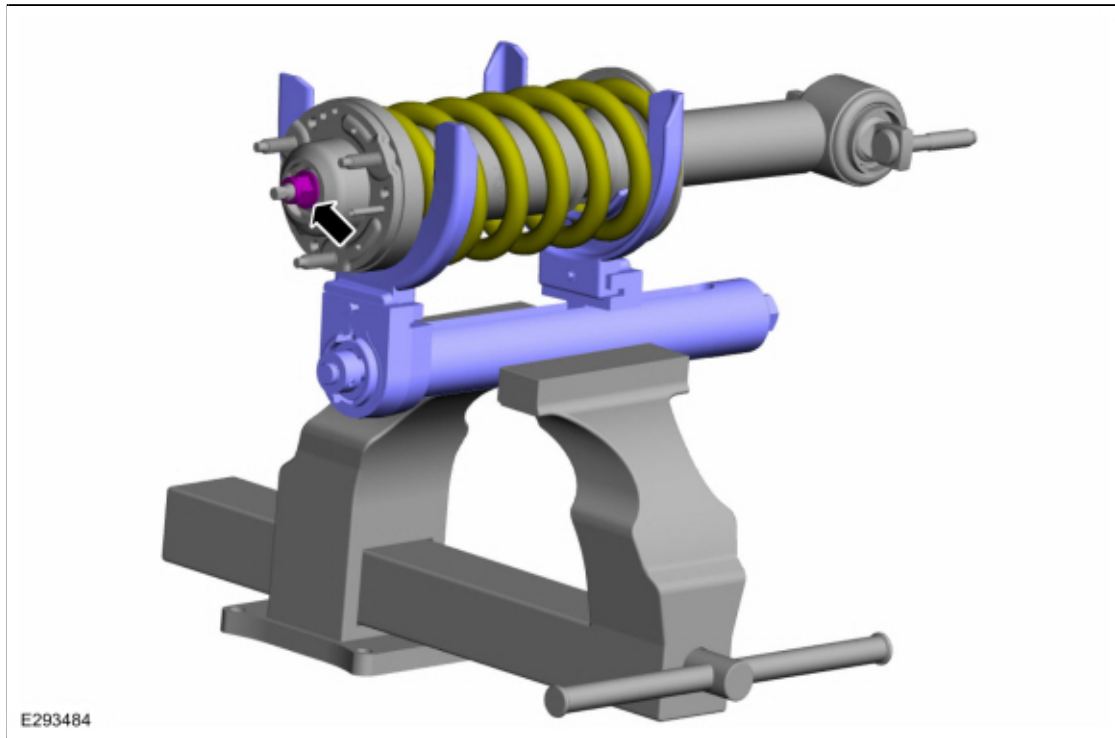

6. Release the spring tension & remove the spring compressor.
Use the General Equipment: Spring Compressor
7. Install the shock absorber and spring assembly.
Refer to: [Shock Absorber and Spring Assembly](#) (204-01A Front Suspension - RWD, Removal and Installation).

