

Fastener Tightening Specifications

Application	Specification	
	Metric	English
Important: Apply Permatex® 24200 or equivalent on all seat belt fasteners prior to installation.		
Center Rear Seat Belt Retractor Cover-to-Seat Bolt	20 N·m	15 lb ft
Center Rear Seat Belt Retractor-to-Seat Bolt	45 N·m	33 lb ft
Center Rear Seat Buckle-to-Seat Bolt	50 N·m	37 lb ft
Child Seat Tether Anchor Bolt-to-Seat	25 N·m	18 lb ft
Front Seat Belt Buckle-to-Seat Bolt	45 N·m	33 lb ft
Front Seat Belt Buckle Quick Connect-to-Seat Bolt	50 N·m	37 lb ft
Front Seat Belt Height Adjuster-to-Pillar	40 N·m	30 lb ft
Front Seat Belt Retractor-to-Center Pillar Bolt	45 N·m	33 lb ft
Front Seat Side Trim Screws	2.5 N·m	22 lb in
Rear Seat Belt Retractor-to-Center Pillar Bolt	45 N·m	33 lb ft
Rear Seat Belt-to-Floor Bolt	45 N·m	33 lb ft
Rear Seat Belt Upper Guide-to-Pillar Bolt	45 N·m	33 lb ft

Driver or Passenger Seat Shoulder Belt Guide Adjuster Replacement

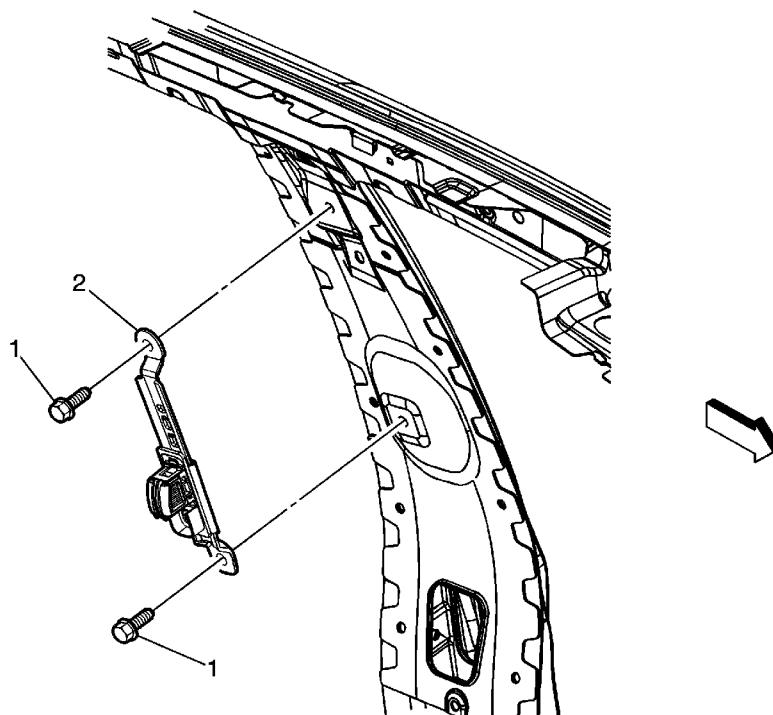

Callout	Component Name
Preliminary Procedures	
<ol style="list-style-type: none">1. Disable the SIR system. Refer to SIR Disabling and Enabling.2. Remove the center pillar upper molding. Refer to Center Pillar Upper Garnish Molding Replacement.3. Remove the front seat belt. Refer to Front Seat Belt Retractor Replacement.	
1	Front Seat Shoulder Belt Guide Adjuster Bolt (Qty: 2) Caution: Refer to Fastener Caution in the Preface section. Tighten 45 N·m (33 lb ft)
2	Front Seat Shoulder Belt Guide Adjuster Assembly

Front Seat Belt Retractor Replacement

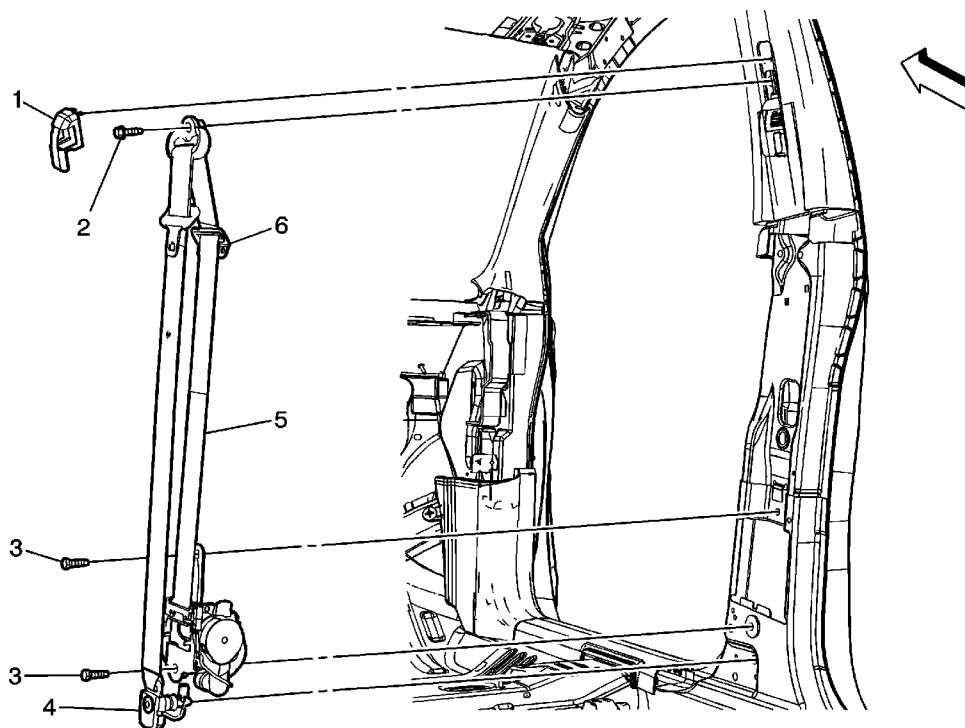

Callout	Component Name
<p>Warning: In order to prevent accidental deployment and the risk of personal injury, do not dispose of an undeployed inflatable restraint seat belt pretensioner as normal shop waste. Undeployed seat belt pretensioners contain substances that could cause severe illness or personal injury if their sealed containers are damaged during disposal. Use the following deployment procedures to safely dispose of an undeployed seat belt pretensioner. Failure to observe the following disposal methods may be a violation of federal, state, or local laws.</p> <p>Warning: Refer to SIR Warning in the Preface section.</p> <h3>Preliminary Procedures</h3> <ol style="list-style-type: none">1. Disable the SIR. Refer to SIR Disabling and Enabling.2. Remove the center pillar lower garnish molding. Refer to Center Pillar Lower Garnish Molding Replacement.	
1	Front Seat Shoulder Belt Guide Adjuster Cover
2	Front Seat Shoulder Belt Guide Bolt
<p>Caution: Refer to Fastener Caution in the Preface section.</p> <p>© 2010 General Motors Corporation. All rights reserved.</p>	

	Tighten 45 N·m (33 lb ft)
3	Front Seat Shoulder Belt Retractor Bolt (Qty: 2) Tighten 45 N·m (33 lb ft)
4	Front Seat Shoulder Belt Anchor Bolt Tighten 10 N·m (88 lb in)
5	Front Seat Shoulder Belt Retractor Procedure Disconnect the electrical connector.
6	Front Seat Shoulder Belt Guide

Seat Belt Schematics

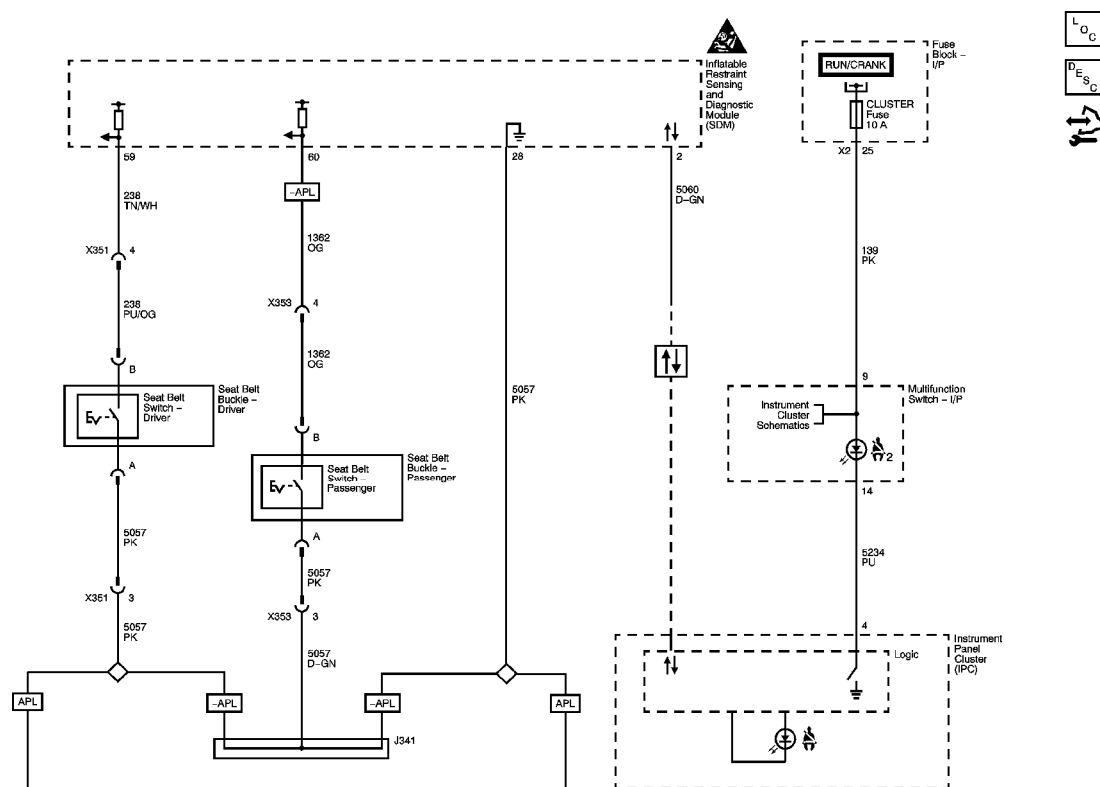

Seat Belt Latch Stop Installation

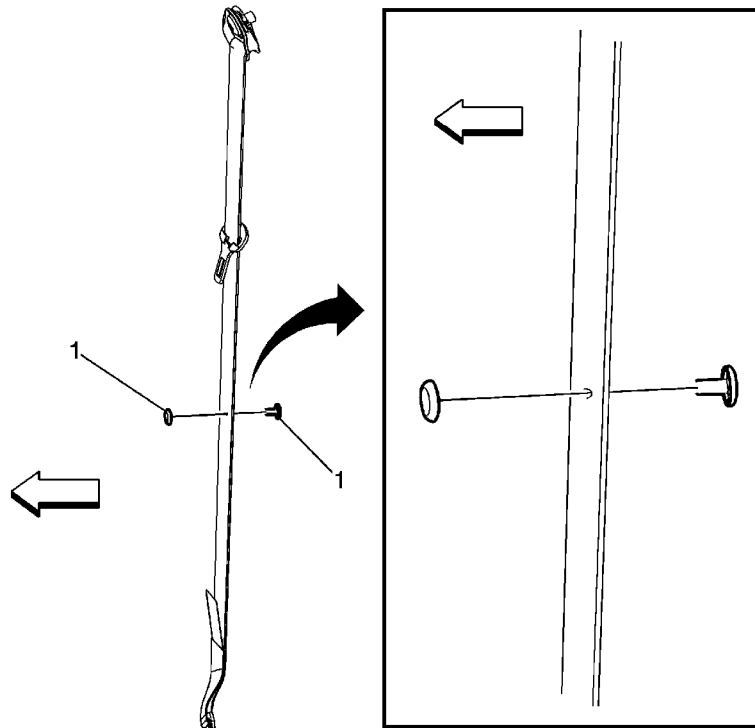

Callout	Component Name
Preliminary Procedure	
<ol style="list-style-type: none">1. Locate the hole in the seat belt webbing where the original seat belt stop button was located.2. If the original hole in the seat belt webbing is not visible, perform the following:<ul style="list-style-type: none">• If either the right or left stop button is missing use the opposing seat belt as a reference.• With the opposing seat belt fully stowed, measure the distance between the seat belt lower anchor and the stop button.• Using the measurement obtained above, measure and mark the location of the missing stop button on the center of the seat belt webbing.3. Ensure the seat belt latch plate is located above the mark or original hole.	
	Seat Belt Stop Button
Procedure	
<ol style="list-style-type: none">1. Work the male half of the stop button through the hole in the webbing or at the marked location.2. Align the female half of the stop button with the male half of the stop button.	

© 2010 General Motors Corporation. All rights reserved.

1

3. Snap the two halves together.
4. Trim off any excess of the male half of the stop button flush with the female half of the stop button.

Tip

Ensure the male half of the stop button is facing forward in the vehicle in order to ensure the stop button will not snag customers clothing.

Driver or Passenger Seat Belt Buckle Replacement

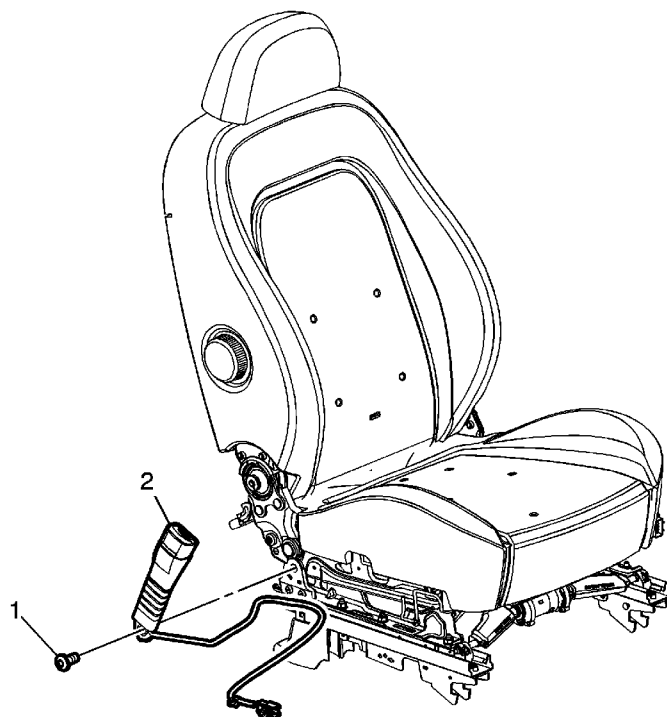

Callout	Component Name
Preliminary Procedures 1. Remove the front seat assembly. Refer to Front Seat Replacement - Bucket . 2. Remove the seat inner adjuster finish cover. Refer to Driver or Passenger Seat Inner Adjuster Finish Cover Replacement .	
1	Seat Belt Buckle Bolt Caution: Refer to Fastener Caution in the Preface section. Tighten 45 N·m (33 lb ft)
2	Seat (Buckle Side) Belt Assembly Procedure Disconnect the electrical connector.

Rear Seat Belt Buckle Replacement (w/40 percent Seat)

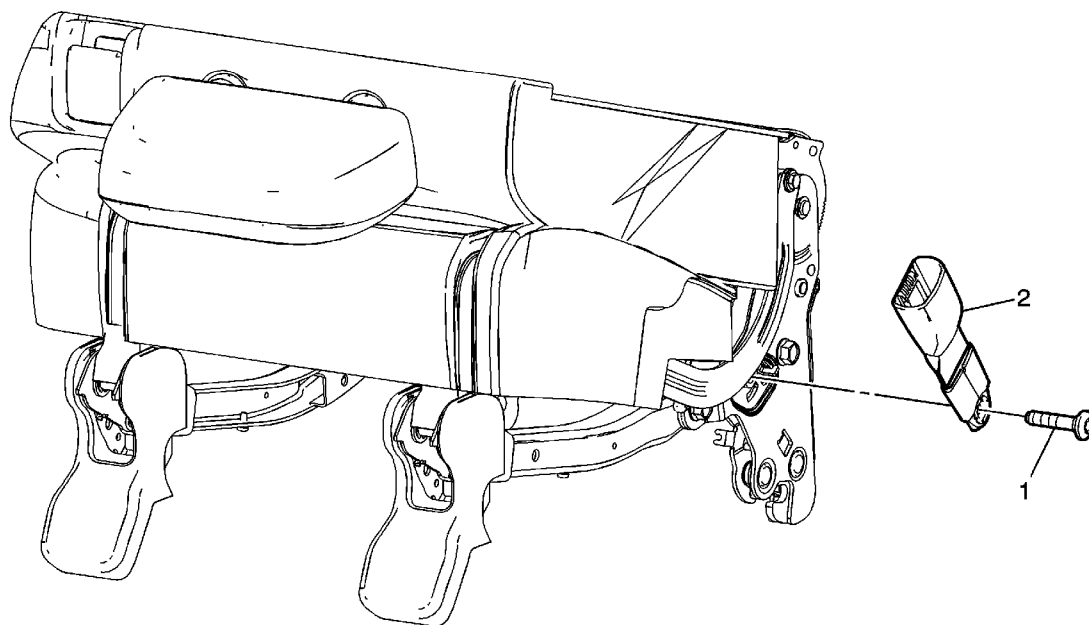

Callout	Component Name
Preliminary Procedures	
<ol style="list-style-type: none">1. Remove the rear seat recliner outer finish cover inboard. Refer to Rear Seat Recliner Outer Finish Cover Replacement - Inboard.2. Fold the seat assembly.	
1	Rear Seat Belt Buckle Bolt Caution: Refer to Fastener Caution in the Preface section. Tighten 45 N·m (33 lb ft)
2	Rear Seat Belt Buckle

Rear Seat Belt Buckle Replacement (w/60 percent Seat)

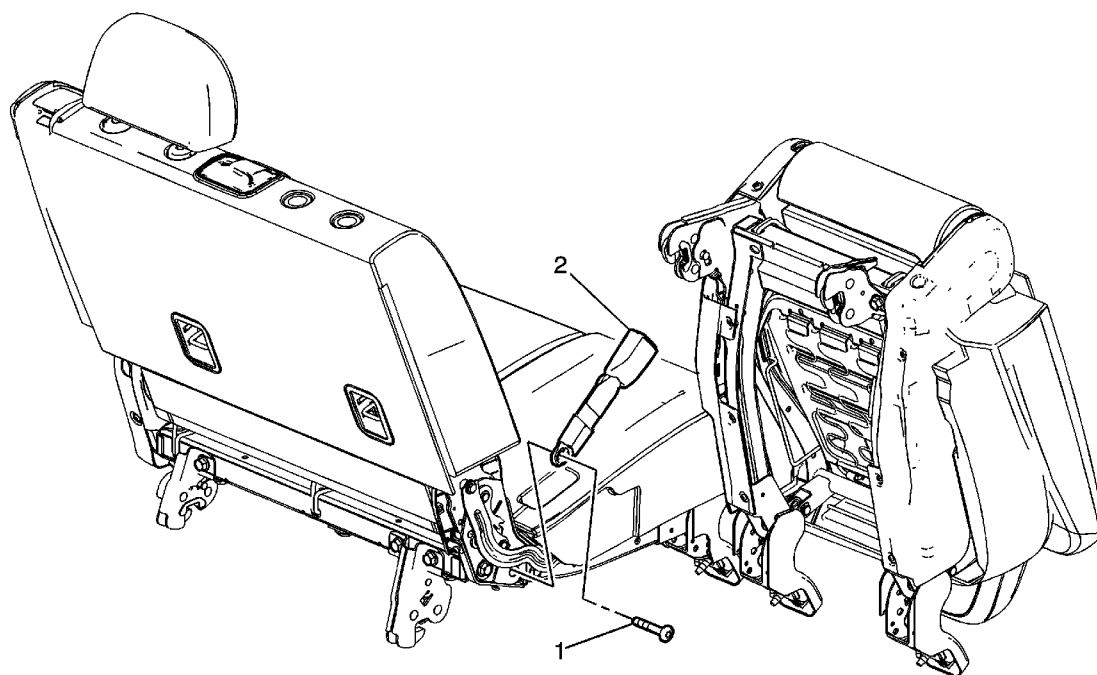

Callout	Component Name
Preliminary Procedure	
Remove the rear seat recliner inner trim finish cover. Refer to Rear Seat Recliner Outer Finish Cover Replacement - Inboard .	
1	Rear Seat Belt Buckle Bolt Caution: Refer to Fastener Caution in the Preface section. Tighten 45 N·m (33 lb ft)
2	Rear Seat Belt Buckle

Rear Seat Center Belt Buckle Replacement

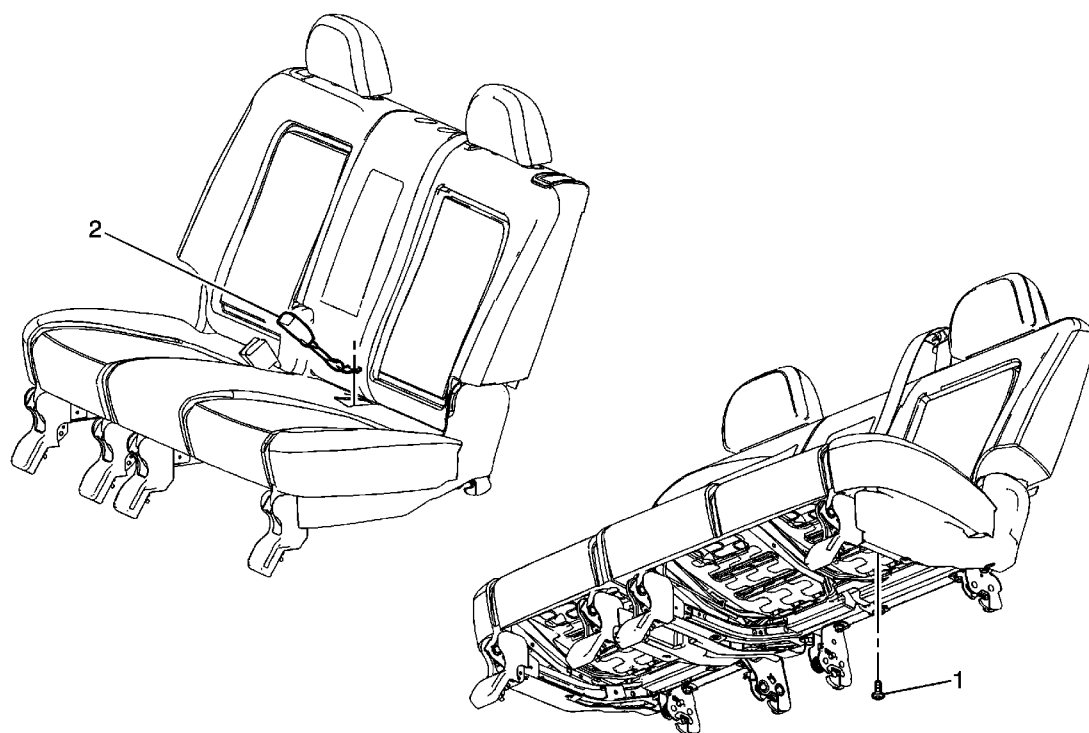

Callout	Component Name
Preliminary Procedure 1. Fold the 60 percent seat back down. 2. Unlatch the rear seat by pushing on the seat latch buttons on the inboard side of the lower rear seat latches.	
1	Rear Seat Center Belt Buckle Bolt Caution: Refer to Fastener Caution in the Preface section. Tighten 45 N·m (33 lb ft)
2	Rear Seat Center Belt Buckle

Rear Seat Belt Replacement

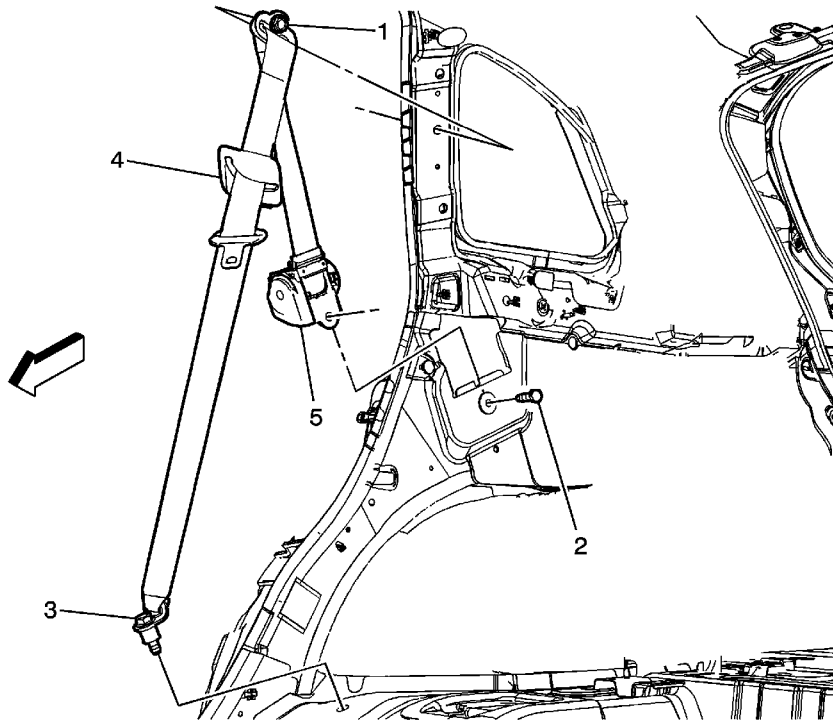

Callout	Component Name
Preliminary Procedures <ol style="list-style-type: none">1. Disable the SIR system. Refer to SIR Disabling and Enabling.2. Remove the rear quarter upper trim Panel. Refer To Quarter Upper Trim Panel Replacement3. Remove the rear quarter lower trim panel. Refer to Quarter Lower Rear Trim Panel Replacement.	
1	Rear Seat Shoulder Belt Guide Adjuster Bolt Caution: Refer to Fastener Caution in the Preface section. Tighten 45 N·m (33 lb ft)
2	Rear Seat Shoulder Belt Retractor Bolt Tighten 45 N·m (33 lb ft)
3	Rear Seat Shoulder Belt Anchor Bolt

© 2010 General Motors Corporation. All rights reserved.

	Tighten 45 N·m (33 lb ft)
4	Rear Seat Shoulder Belt Guide
5	Rear Seat Shoulder Belt Retractor Assembly

Seat Belt Replacement - Center Rear

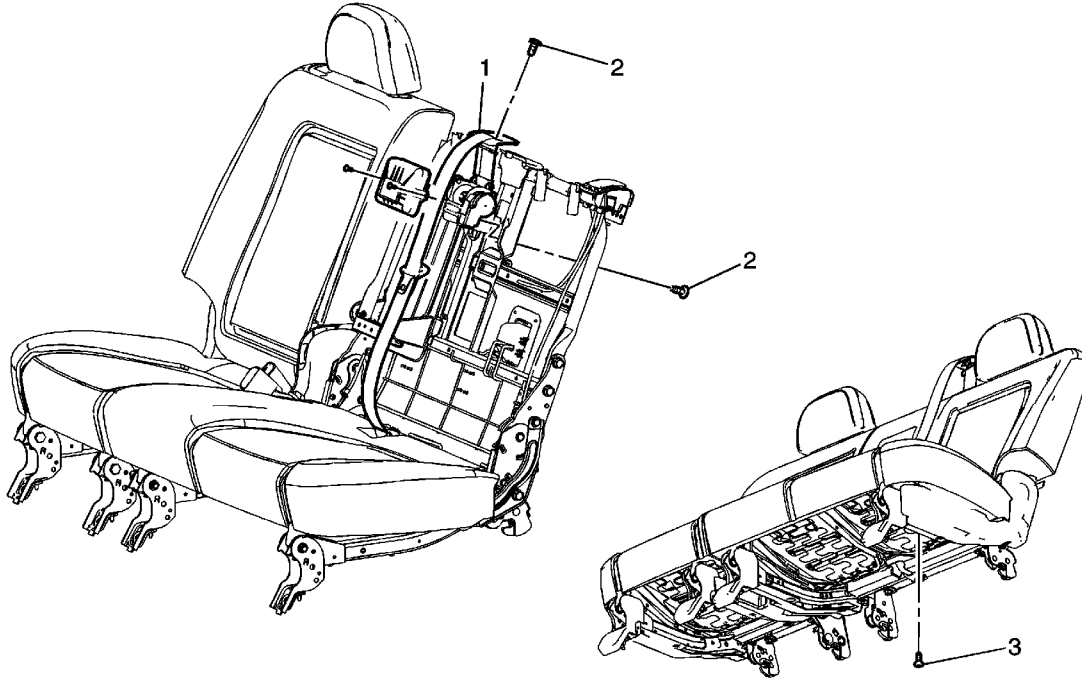

Callout	Component Name
Preliminary Procedure	
Remove rear seat back cushion and cover. Refer to Rear Seat Back Cushion Cover and Pad Replacement .	
1	Rear Seat Center Belt Retractor Assembly Procedure Tilt the 40 percent seat forward for access.
2	Rear Seat Center Belt Retractor Bolt (Qty: 2) Caution: Refer to Fastener Caution in the Preface section. Tighten 45 N·m (33 lb ft)
3	Rear Seat Center Belt Retractor Anchor Bolt Tighten

© 2010 General Motors Corporation. All rights reserved.

45 N·m (33 lb ft)
