

[2009 Saturn VUE - AWD](#) | [VUE, VUE Hybrid \(VIN Z\), Captiva Sport Service Manual](#) | [Body Hardware and Trim](#) | [Interior Trim and Paneling](#) | [Specifications](#) | **Document ID: 1876749**

Fastener Tightening Specifications

Application	Specification	
	Metric	English
Console Cup Holder Track Screw	2.5 N·m	22 lb in
Door Trim Panel Bolts	2.5 N·m	22 lb in
Door Trim Pull Handle Bolts	2.5 N·m	22 lb in
Floor Console Cupholder Screws	2 N·m	18 lb in
Garnish Molding Screws	2 N·m	18 lb in
Liftgate Trim Panel Screws	2.5 N·m	22 lb in
Load Floor Storage Bin Bolts	2.5 N·m	22 lb in
Shoulder Belt Assembly Bolts	50 N·m	37 lb ft
Sunshade Anchor Screws	2.5 N·m	22 lb in
Sunshade Screws	2.5 N·m	22 lb in

Front Side Door Trim Panel Replacement

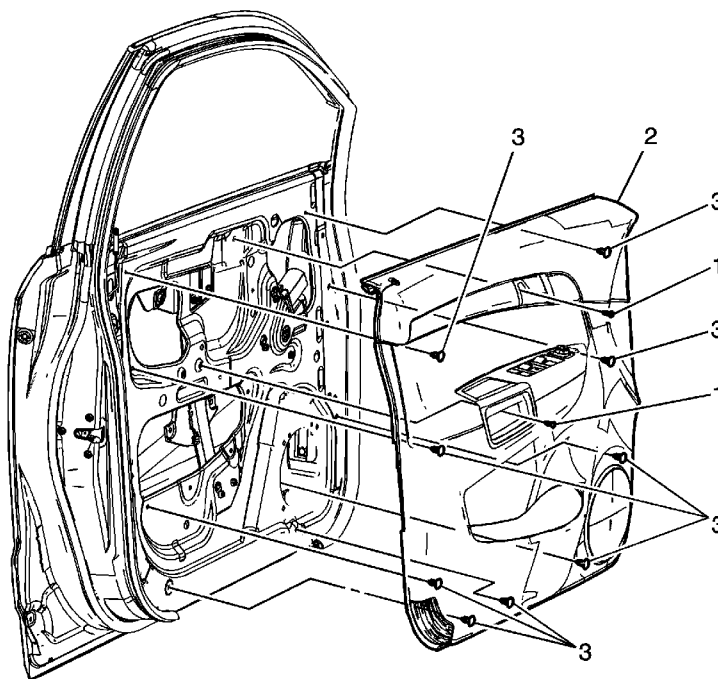

Callout	Component Name
1	Front Side Door Trim Panel Bolt (Qty: 3) Caution: Refer to Fastener Caution in the Preface section. Tighten 2 N·m (18 lb in)
2	Front Side Door Trim Panel Assembly Procedure 1. Disengage the door lock cable. 2. Disconnect the electrical connector.
3	Front Side Door Trim Panel Retainer (Qty: 9)

Rear Side Door Trim Panel Replacement

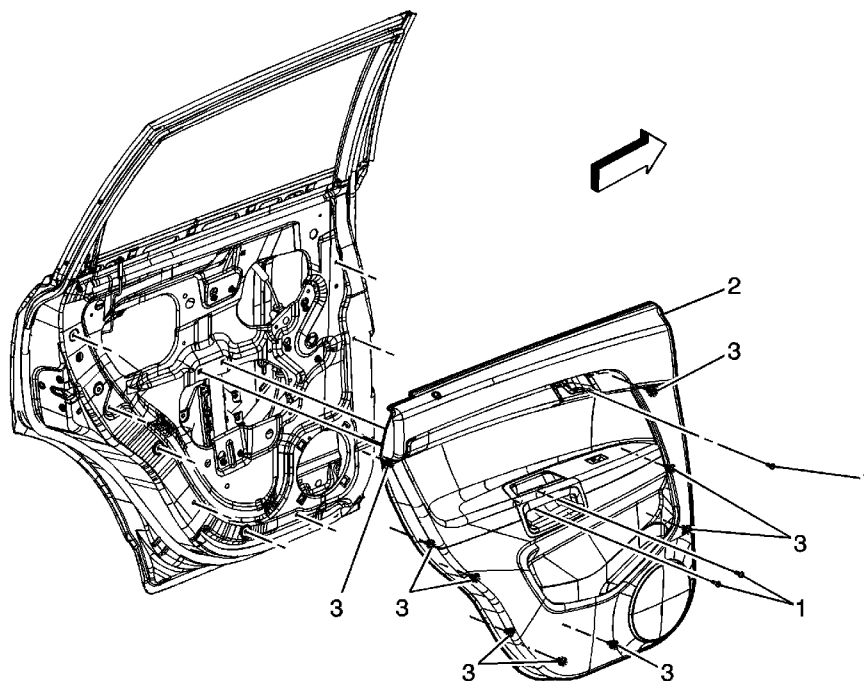

Callout	Component Name
Preliminary Procedure	
Remove the rear side door upper rear trim panel. Refer to Rear Side Door Upper Rear Trim Panel Replacement .	
1	Rear Side Door Trim Panel Screw (Qty: 3) Caution: Refer to Fastener Caution in the Preface section. Tighten 2 N·m (18 lb in)
2	Rear Side Door Trim Panel Assembly Procedure 1. Disengage the door lock cable. 2. Disconnect the electrical connector.
3	Rear Side Door Trim Panel Retainer (Qty: 9)

Rear Side Door Upper Rear Trim Panel Replacement

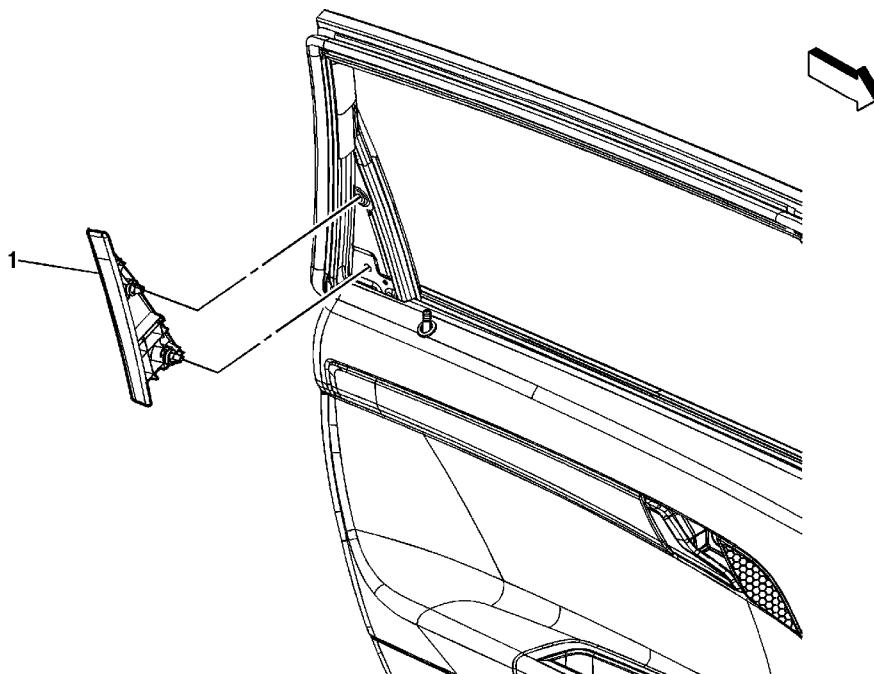

Callout	Component Name
1	Rear Side Door Upper Rear Trim Panel Assembly
Procedure	
Pull door upper rear trim panel away from the rear side door.	

Liftgate Door Sill Plate Replacement

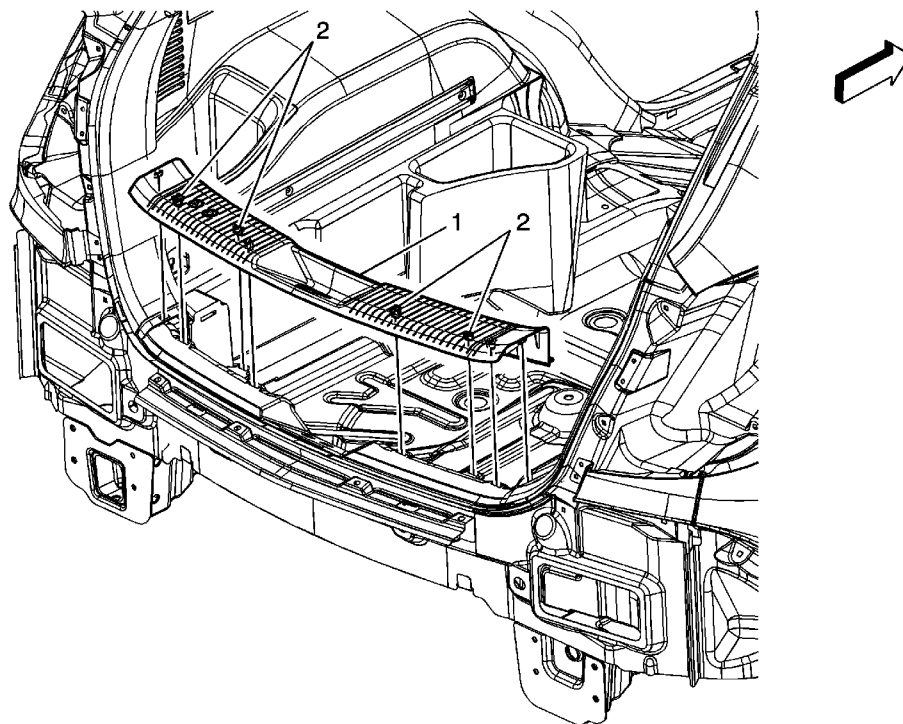

Callout	Component Name
1	Liftgate Door Sill Plate Assembly Procedure 1. Lift storage compartment lid. 2. Remove foam over spare tire. 3. Use a flat-bladed plastic trim tool in order to release the clips and remove the sill plate.
2	Liftgate Door Sill Plate Clip (Qty: 4)

Front Assist Handle Replacement

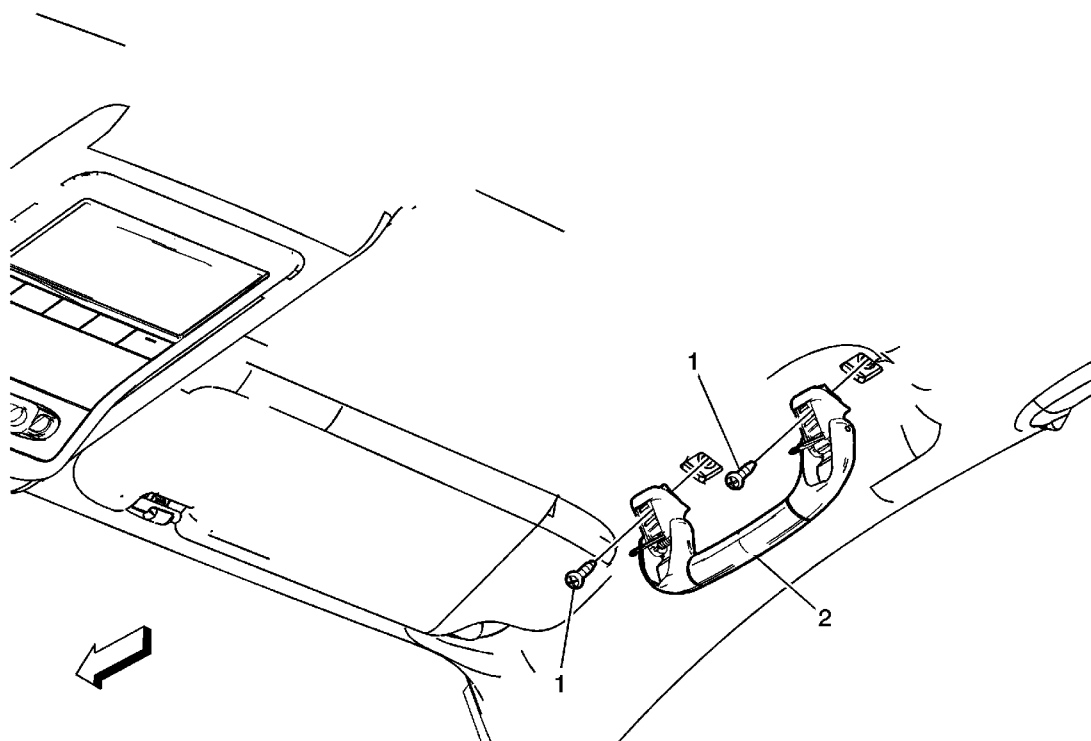

Callout	Component Name
1	<p>Roof Rail Front Assist Handle Screw (Qty: 2)</p> <p>Caution: Refer to Fastener Caution in the Preface section.</p> <p>Procedure</p> <ol style="list-style-type: none">1. Fold the assist handle downward and hold.2. Use a small flat-bladed tool to open the assist handle covers to access the screws. <p>Tighten 6 N·m (53 lb in)</p>
2	Roof Rail Front Assist Handle

Assist Handle and Rear Coat Hook Replacement

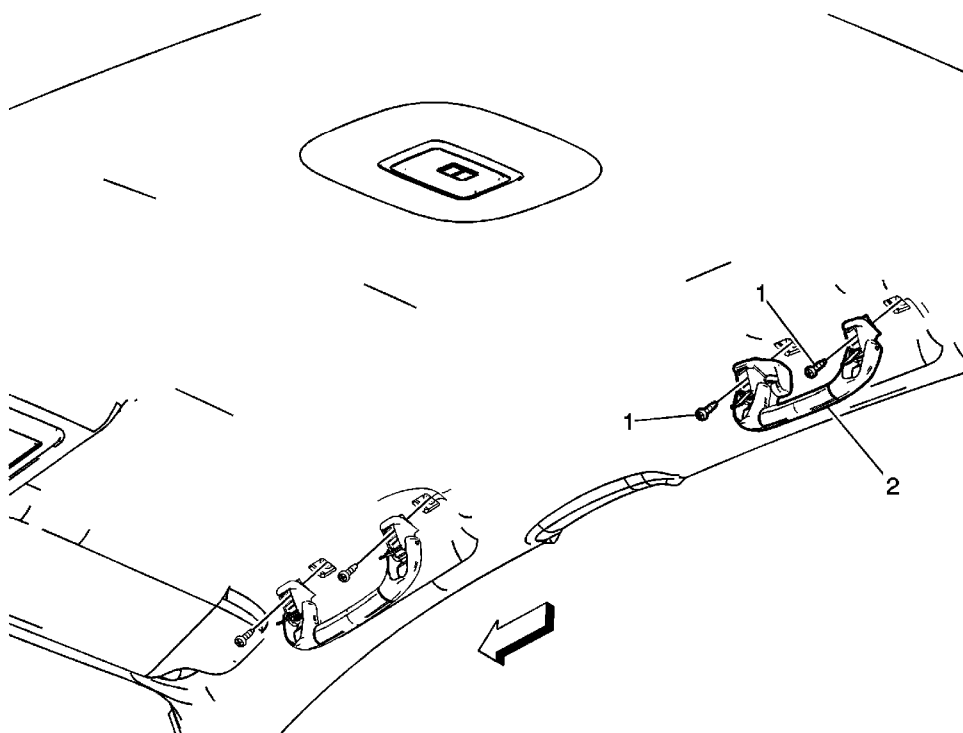

Callout	Component Name
1	<p>Roof Rail Rear Assist Handle Screw (Qty: 2)</p> <p>Caution: Refer to Fastener Caution in the Preface section.</p> <p>Procedure</p> <ol style="list-style-type: none">1. Fold the assist handle downward and hold.2. Use a small flat bladed tool to open the assist handle covers to access the screws. <p>Tighten 6 N·m (53 lb in)</p>
2	Roof Rail Rear Assist Handle

Sunshade Replacement

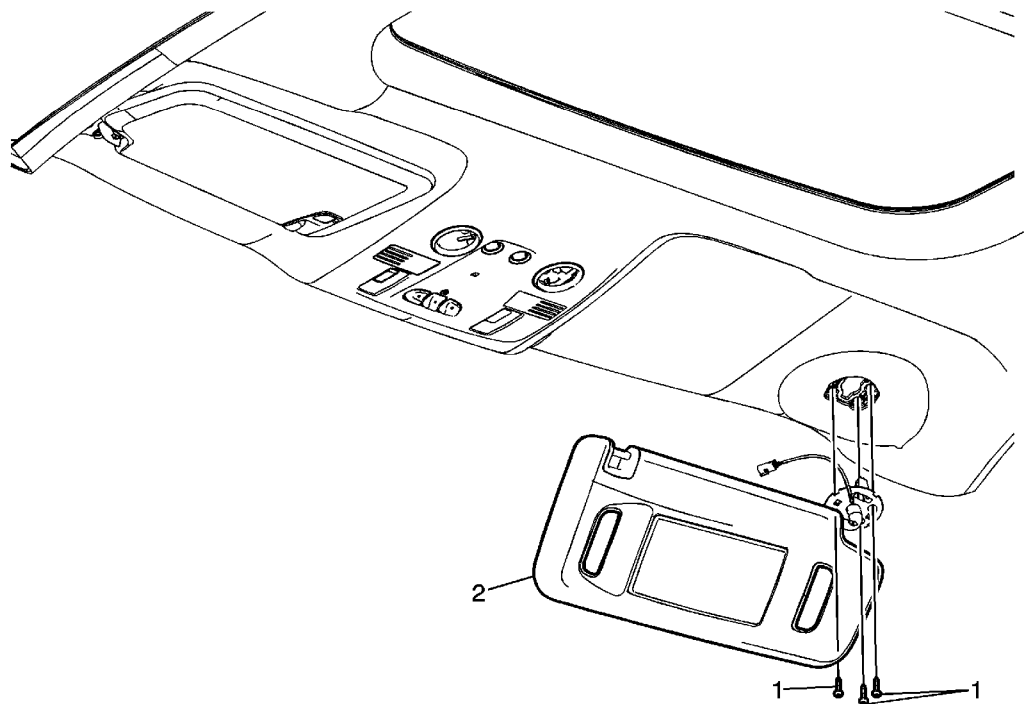

Callout	Component Name
Preliminary Procedures	
1. Remove windshield pillar garnish molding. Refer to Windshield Pillar Garnish Molding Replacement .	
2. Remove front assist handle. Refer to Front Assist Handle Replacement .	
1	Sunshade Screw (Qty: 3) Caution: Refer to Fastener Caution in the Preface section. Tighten 3 N·m (25 lb in)
2	Sunshade Assembly Procedure Disconnect the electrical connector.

Sunshade Anchor Replacement

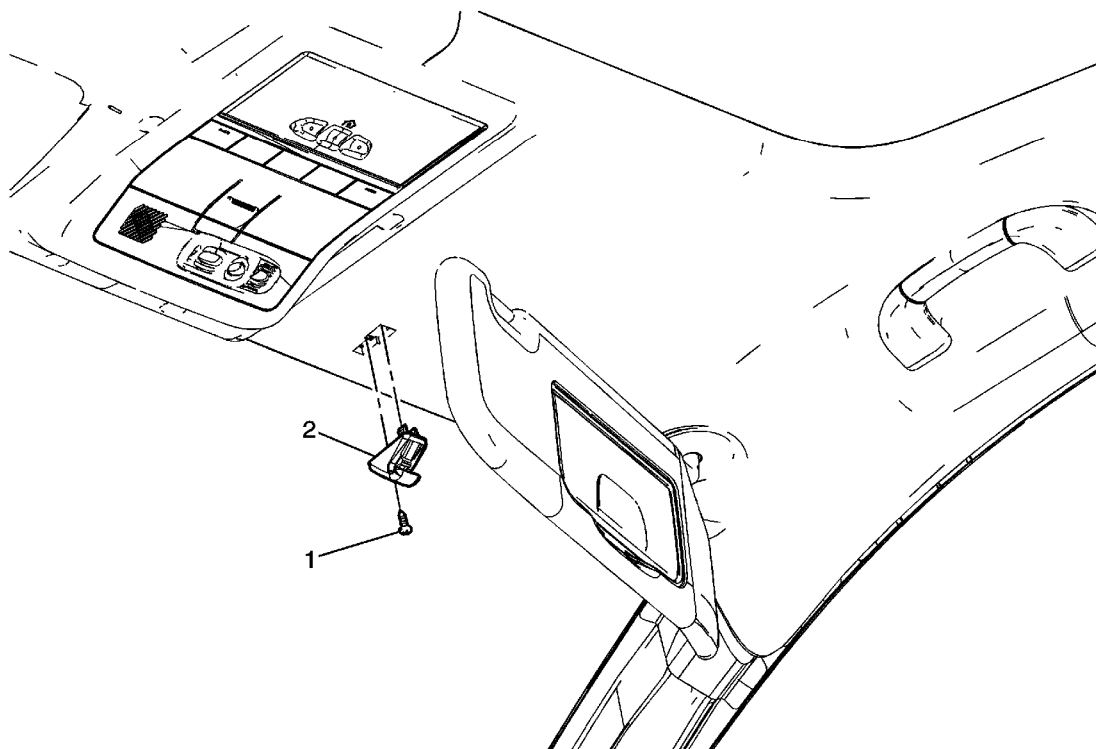

Callout	Component Name
1	Sunshade Anchor Screw Caution: Refer to Fastener Caution in the Preface section. Tighten 3 N·m (27 lb in)
2	Sunshade Anchor Tip Disengage the sunshade from the retainer.

Windshield Pillar Garnish Molding Replacement

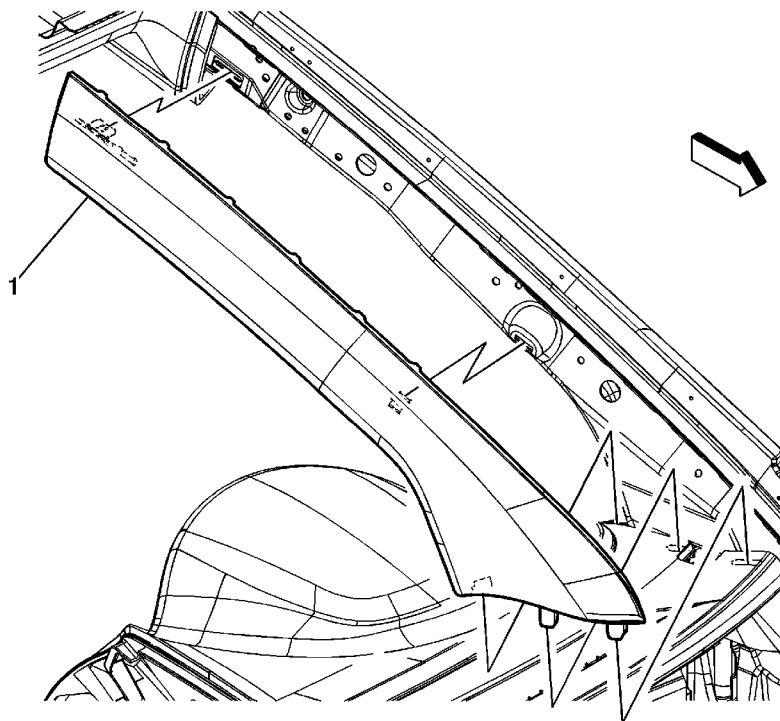

Callout	Component Name
Preliminary Procedure	
Disable the SIR system. Refer to SIR Disabling and Enabling .	
	Windshield Garnish Molding Assembly
	Procedure
1	<ol style="list-style-type: none">1. Tether at upper portion of garnish molding needs to be disconnected for removal and reattached for installation.2. Starting at the top, gently pull on the garnish molding to disengage the clip.3. Tabs must be installed prior to retainer clip.4. Tabs to be fully seated in instrument panel trim panel retainer and valance panel.

Center Pillar Upper Garnish Molding Replacement

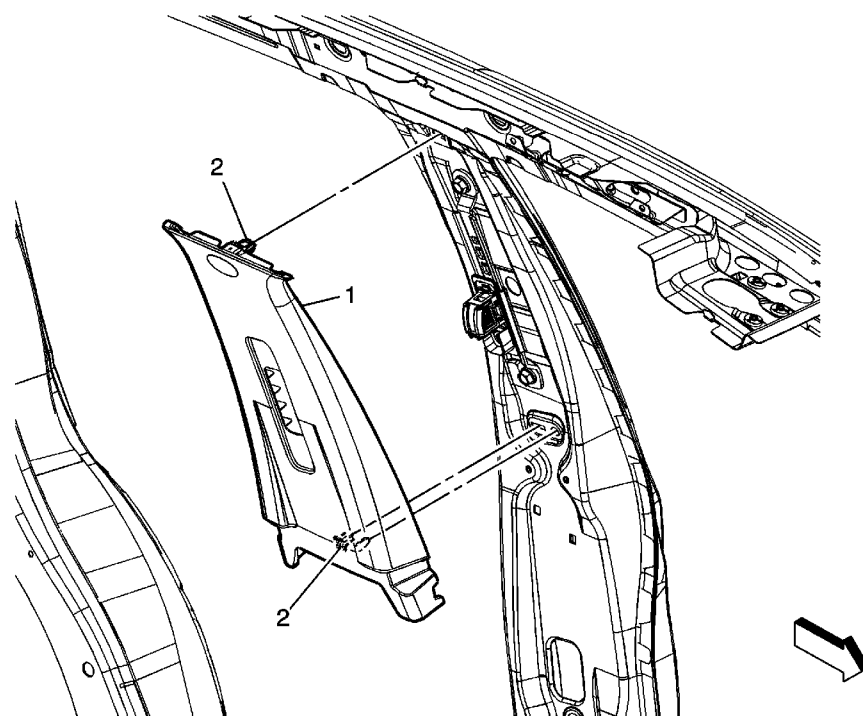

Callout	Component Name
Preliminary Procedure	
Remove the center pillar lower garnish molding. Refer to Center Pillar Lower Garnish Molding Replacement .	
1	Center Pillar Upper Garnish Molding Assembly Procedure Remove the shoulder belt bolt from the shoulder belt adjuster. Refer to Front Seat Belt Retractor Replacement .
2	Center Pillar Upper Garnish Molding Clip (Qty: 2)

Center Pillar Lower Garnish Molding Replacement

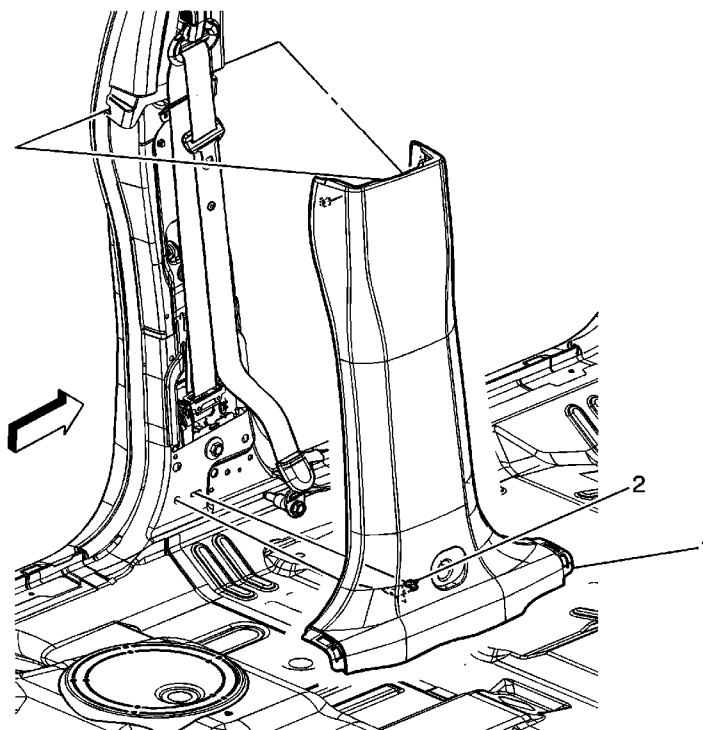

Callout	Component Name
Preliminary Procedures	
<ol style="list-style-type: none">1. Remove the front carpet retainer. Refer to Front Carpet Retainer Replacement.2. Remove the rear carpet retainer. Refer to Rear Carpet Retainer Replacement.3. Remove the seat belt anchor bolt from the center pillar. Refer to Front Seat Belt Retractor Replacement.	
1	Center Pillar Lower Garnish Molding Assembly Tip There are 2 locating pins at the top of the molding for alignment purposes.
2	Center Pillar Lower Garnish Molding Clip (Qty: 2)

Quarter Upper Trim Panel Replacement

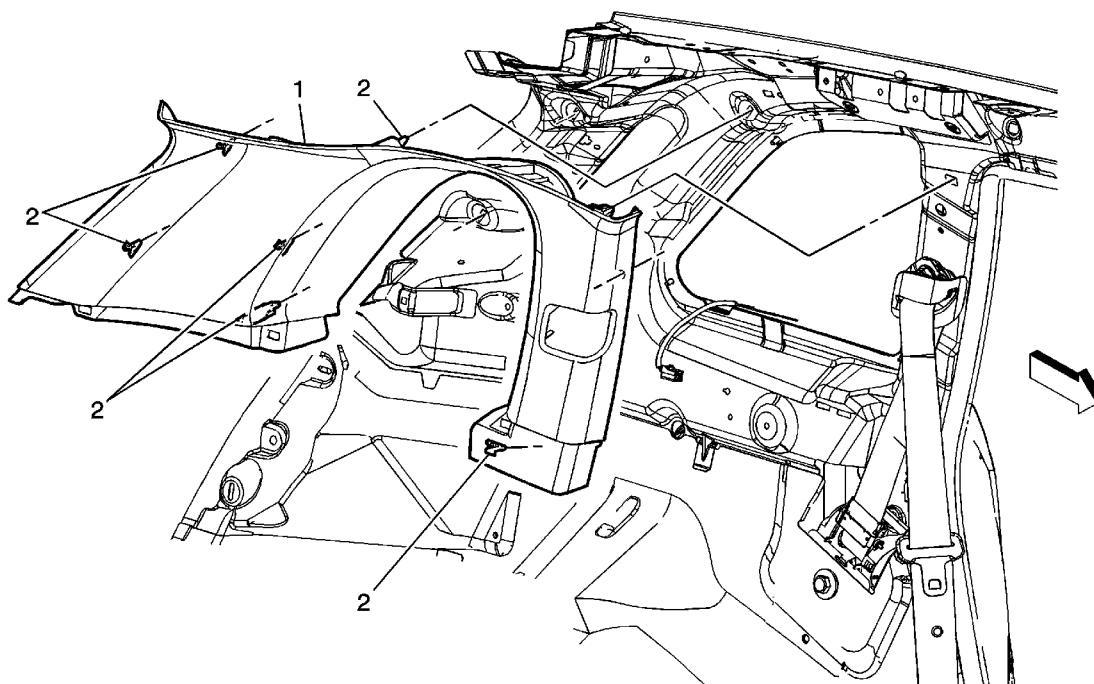

Callout	Component Name
Preliminary Procedures 1. Disable the SIR system. Refer to SIR Disabling and Enabling . 2. Remove the rear quarter lower trim panel. Refer to Quarter Lower Rear Trim Panel Replacement .	
1	Rear Quarter Upper Trim Panel Assembly Procedure 1. Loosen the rear compartment opening weather-strip. 2. Route the seat belt through trim panel.
2	Rear Quarter Upper Trim Panel Clip (Qty: 6)

Quarter Lower Rear Trim Panel Replacement

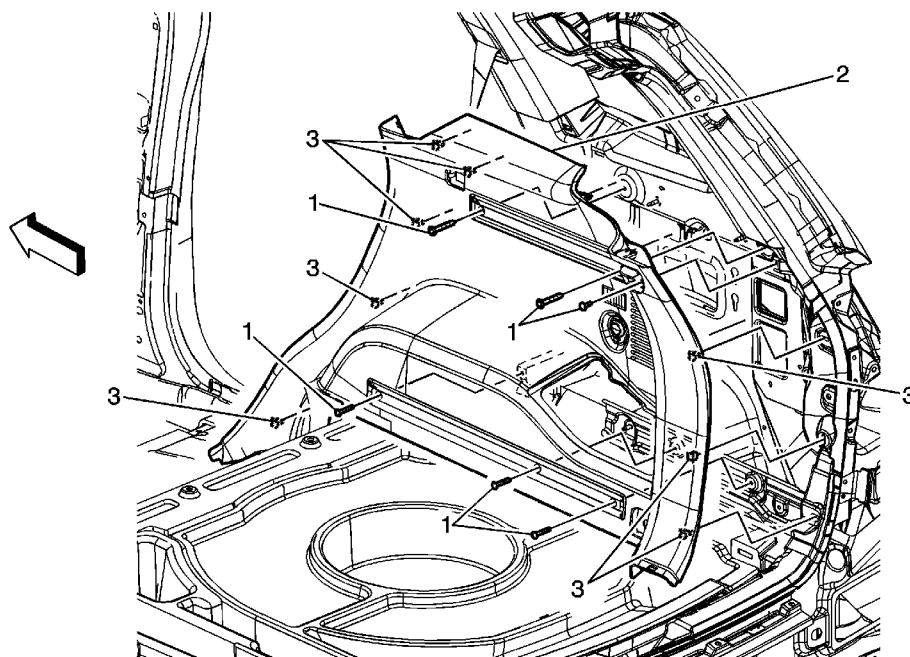

Callout	Component Name
Preliminary Procedures <ol style="list-style-type: none">1. Remove cargo accessory shelves, if equipped.2. Remove the rear seat belt anchor bolt. Refer to Rear Seat Belt Replacement.3. Remove the liftgate door sill plate. Refer to Liftgate Door Sill Plate Replacement.4. Rotate rear seats to the forward position.	
1	Rear Quarter Lower Trim Panel Retaining Screw (Qty: 6) Caution: Refer to Fastener Caution in the Preface section. Tighten 6 N·m (53 lb ft)
2	Rear Quarter Lower Trim Panel Assembly Procedure Disconnect the electrical connectors.
3	Rear Quarter Lower Trim Panel Retainer (Qty: 6)

Floor Panel Extension Support Replacement (2 Mode)

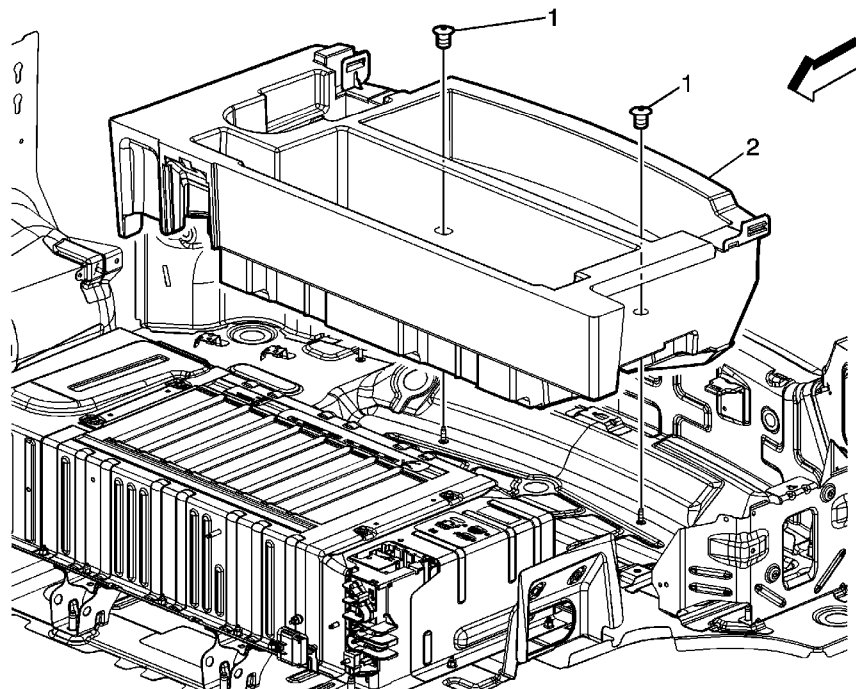

Callout	Component Name
Preliminary Procedure	
Remove the rear compartment floor stowage compartment cover. Refer to Rear Compartment Floor Stowage Compartment Cover Replacement .	
1	Rear Compartment Floor Stowage Compartment Fastener Caution: Refer to Fastener Caution in the Preface section. Tighten 3 N·m (27 lb in)
2	Floor Panel Extension Support

Rear Compartment Floor Stowage Compartment Replacement (HP7)

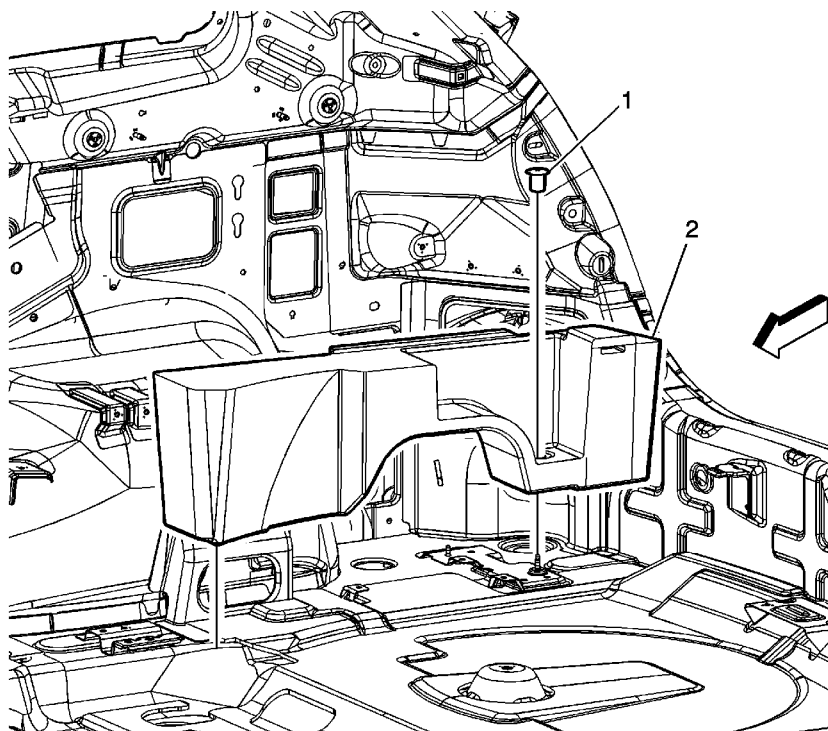

Callout	Component Name
Preliminary Procedures	
<ol style="list-style-type: none">1. Remove the rear quarter lower trim panel. Refer to Quarter Lower Rear Trim Panel Replacement.2. Remove the rear compartment floor stowage compartment cover. Refer to Rear Compartment Floor Stowage Compartment Cover Replacement.	
1	Rear Compartment Floor Stowage Compartment Bolt Caution: Refer to Fastener Caution in the Preface section. Tighten 3 N·m (27 lb in)
2	Rear Compartment Floor Stowage Compartment Assembly

Rear Compartment Floor Stowage Compartment Replacement (Without HP7)

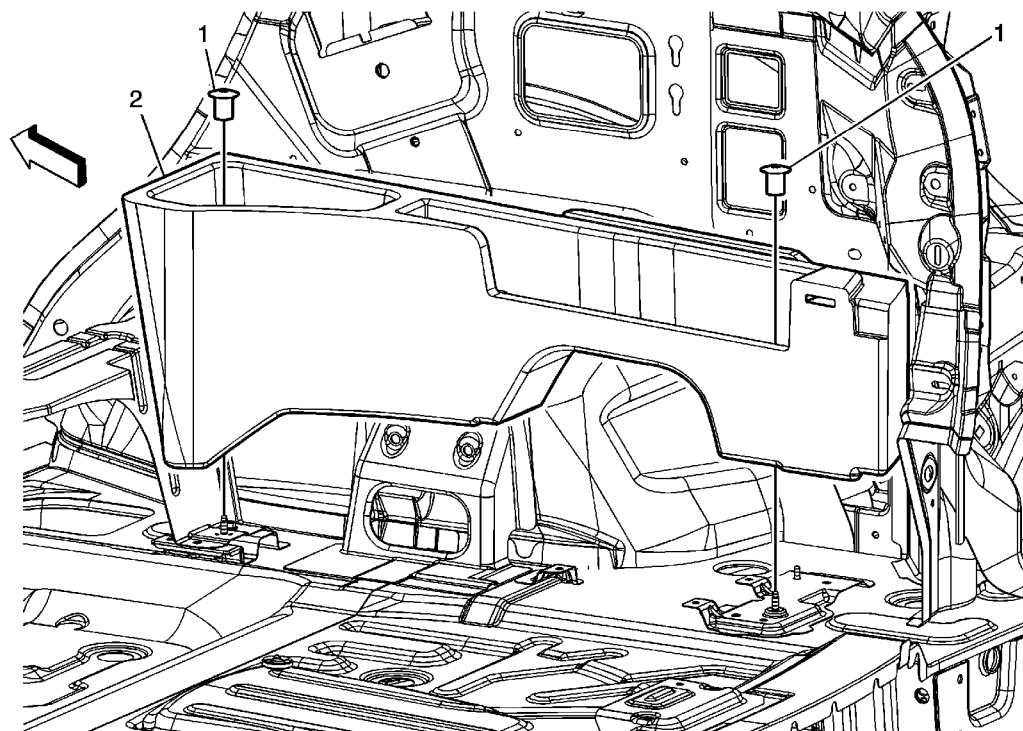

Callout	Component Name
Preliminary Procedures	
<ol style="list-style-type: none">1. Remove the rear quarter lower trim panel. Refer to Quarter Lower Rear Trim Panel Replacement.2. Remove the rear compartment floor stowage compartment cover. Refer to Rear Compartment Floor Stowage Compartment Replacement.	
1	Rear Compartment Floor Stowage Compartment Bolt (Qty: 2) Caution: Refer to Fastener Caution in the Preface section. Tighten 3 N·m (27 lb in)
2	Rear Compartment Floor Stowage Compartment Assembly

Rear Compartment Floor Stowage Compartment Cover Replacement

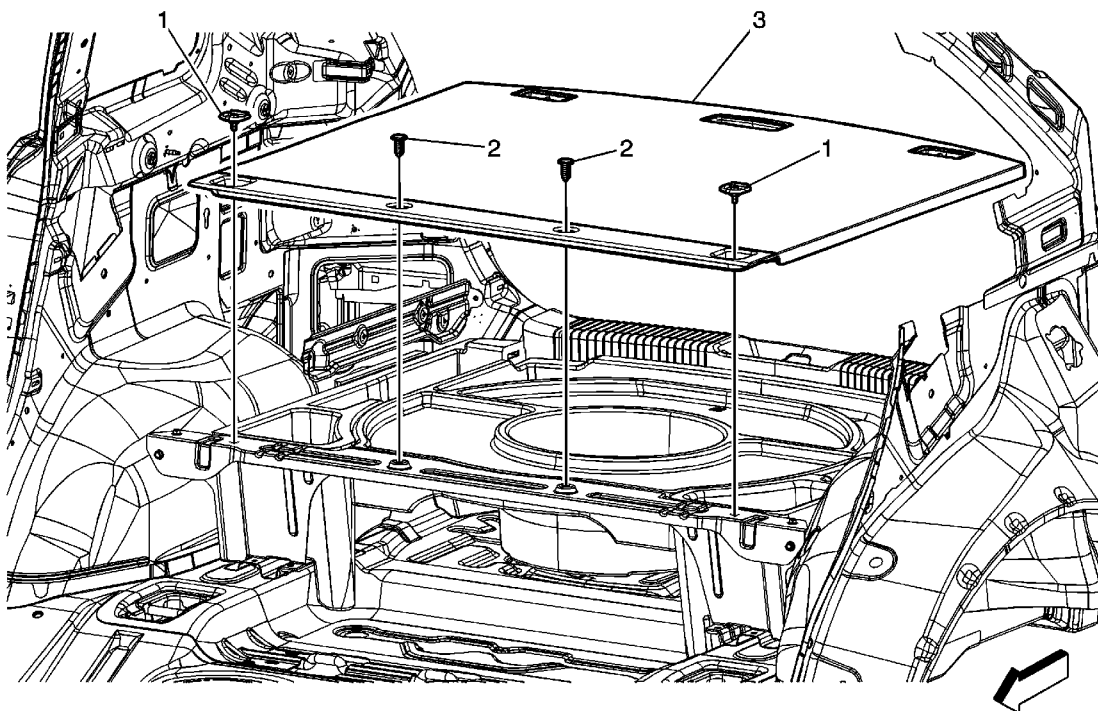

Callout	Component Name
1	Cargo Tie Down Loop Bolt (Qty: 2) Caution: Refer to Fastener Caution in the Preface section. Tighten 10 N·m (89 lb in)
2	Rear Compartment Floor Stowage Compartment Cover Retainer (Qty: 2)
3	Rear Compartment Floor Stowage Compartment Cover Tip Push the rear latches inward to release the two rear latches.

Rear Compartment Floor Stowage Compartment Support Replacement (HP7)

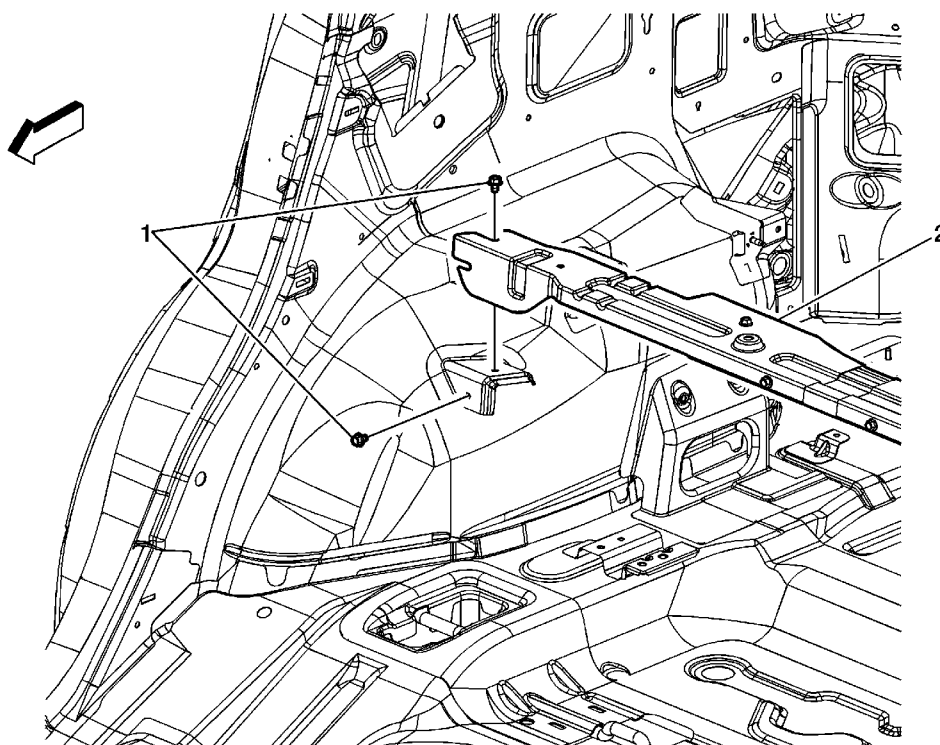

Callout	Component Name
Preliminary Procedures	
<ol style="list-style-type: none">1. Remove the rear compartment floor stowage compartment cover. Refer to Rear Compartment Floor Stowage Compartment Replacement.2. Unlatch the rear seat by pushing forward on the seat latch buttons located on the inboard side of the lower rear seat latches.	
1	Rear Compartment Floor Stowage Compartment Support Bolt (Qty: 4) Caution: Refer to Fastener Caution in the Preface section. Tighten 10 N·m (89 lb in)
2	Rear Compartment Floor Stowage Compartment Support

Rear Compartment Floor Stowage Compartment Support Replacement (Without HP7)

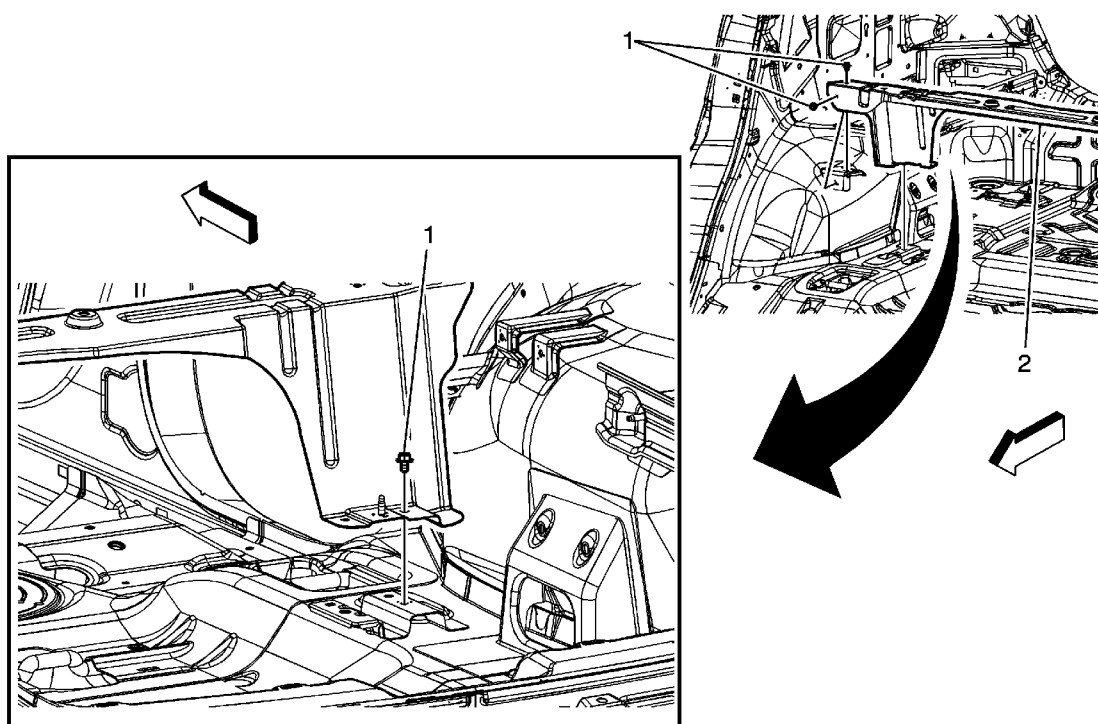

Callout	Component Name
Preliminary Procedures	
<ol style="list-style-type: none">1. Remove the rear compartment floor stowage compartment cover. Refer to Rear Compartment Floor Stowage Compartment Replacement.2. Unlatch the rear seat by pushing forward on the seat latch buttons located on the inboard side of the lower rear seat latches.	
1	Rear Compartment Floor Stowage Compartment Support Bolt (Qty: 6) Caution: Refer to Fastener Caution in the Preface section. Tighten 10 N·m (89 lb in)
2	Rear Compartment Floor Stowage Compartment Support

Body Side Rear Stowage Compartment Replacement

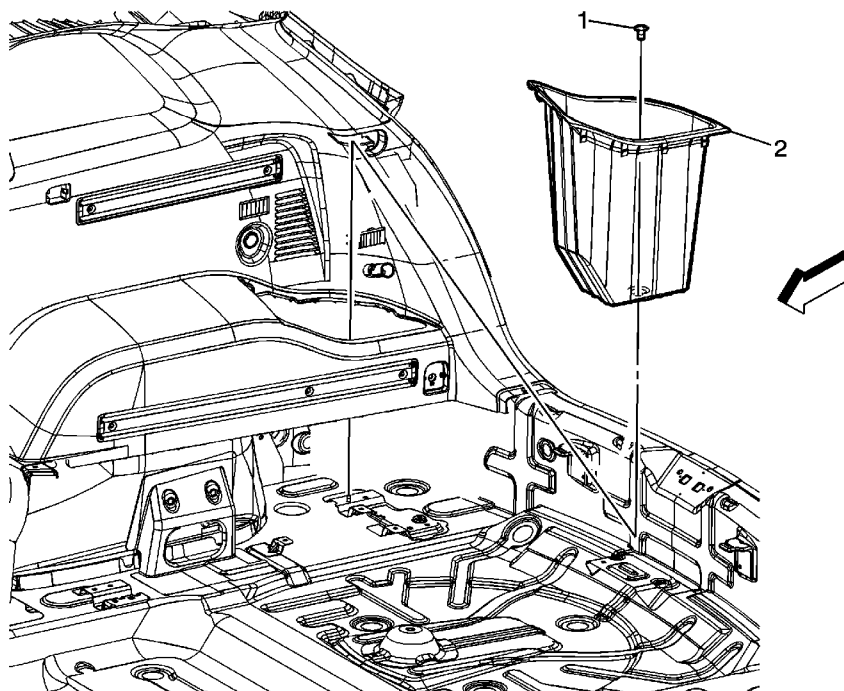

Callout	Component Name
1	Body Side Rear Stowage Compartment Retainer
2	Body Side Rear Stowage Compartment
	Tip Pull upward to disengage the retainers along the top of the stowage compartment.

Liftgate Garnish Molding Replacement

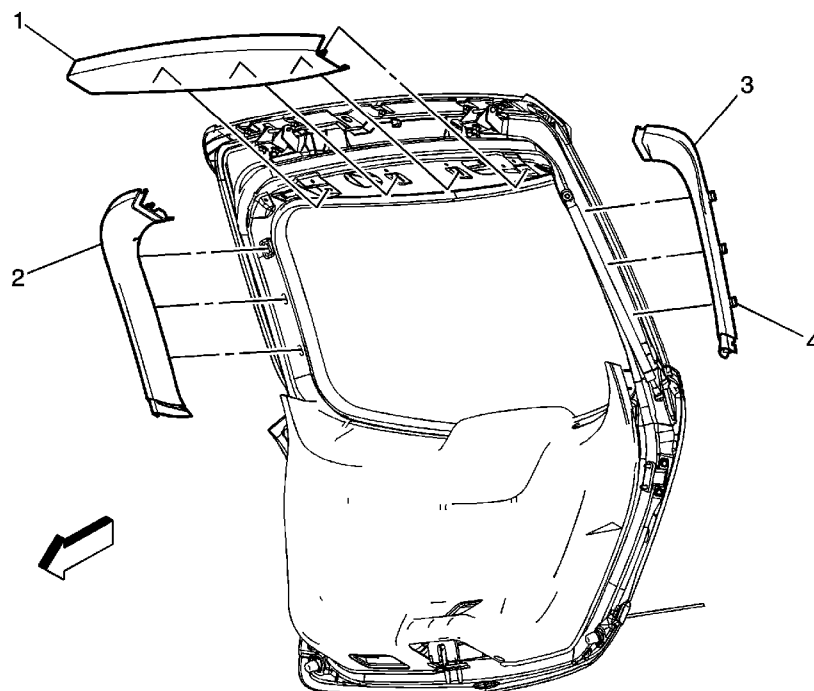

Callout	Component Name
1	Liftgate Upper Trim Finish Panel
2	Liftgate Right Trim Finish Panel
3	Liftgate Left Trim Finish Panel
4	Liftgate Trim Finish Panel Retainer Clip

Liftgate Trim Panel Replacement

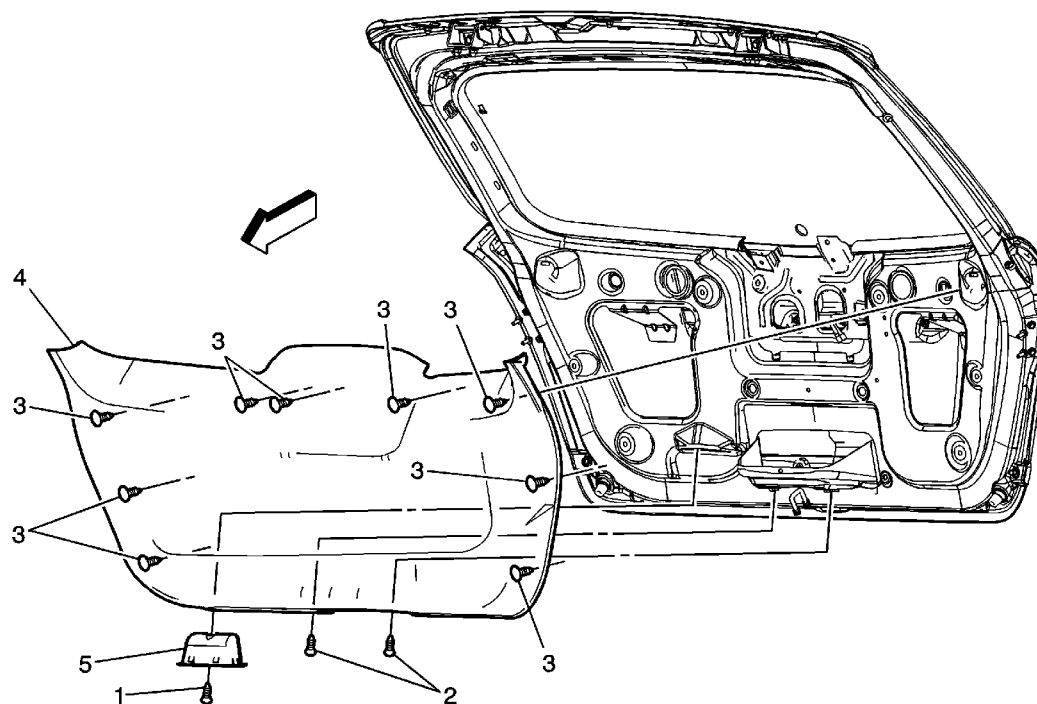

Callout	Component Name
Preliminary Procedure	
Remove the liftgate window garnish molding. Refer to Liftgate Garnish Molding Replacement .	
1	Liftgate Inside Pull Handle Screw Caution: Refer to Fastener Caution in the Preface section. Tighten 2 N·m (18 lb in)
2	Liftgate Trim Finish Panel Screw (Qty: 2) Tighten 2 N·m (18 lb in)
3	Liftgate Trim Finish Panel Retainer (Qty: 9)
4	Liftgate Trim Finish Panel
5	Liftgate Trim Finish Panel Pull Handle